



Current Tools

FOR THE PROFESSIONAL ELECTRICIAN



Model 157PM Ratchet Knockout Set

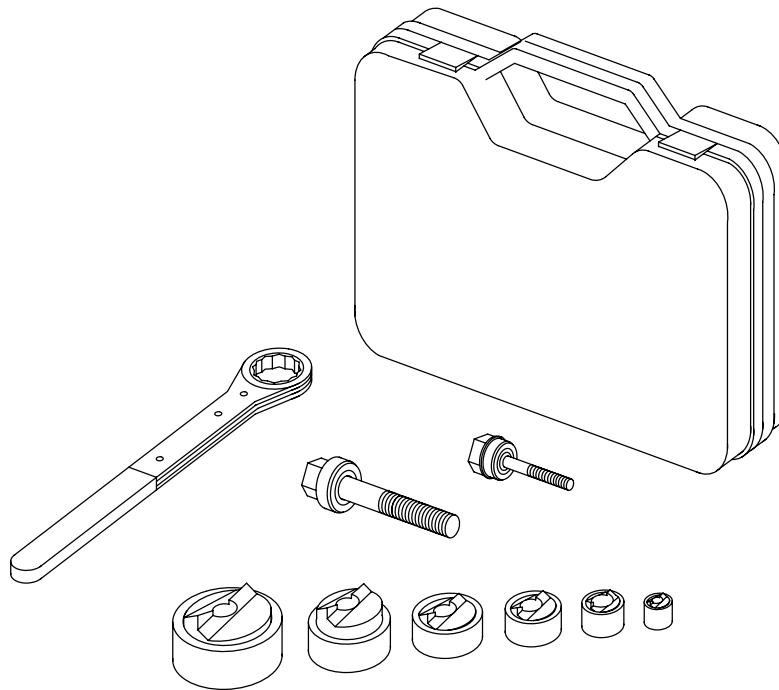

Operating, Safety and Parts Manual

01/2020



Read and understand this material before using the Ratchet Knockout Set. Failure to understand how to safely operate this unit may result in serious injury or death.

This manual is free of charge. All personnel who operate or service this Ratchet Knockout Set should have a copy of this manual and read and understand its contents. To request a copy, call, write to the address below or visit our website at www.currenttools.com. All information, specifications and product designs may change due to design improvements or updates and are subject to change without notice. Current Tools does not assume any liability for damages resulting from misuse or incorrect application of its products.

**CURRENT TOOLS • P. O. BOX 17026 GREENVILLE, SC 29606
800.230.5421 or 864.721-4230 • FAX 864.721.4232
www.currenttools.com**

TABLE OF CONTENTS

<i>Safety Alerts</i>	2
<i>Important Safety Information</i>	3
<i>Specifications</i>	4
<i>Operating Instructions</i>	4-5
<i>Parts List</i>	5

SAFETY ALERTS



Safety Alert Symbol

THIS SAFETY SYMBOL is used to call your attention to instructions that concern your personal safety. It means: ATTENTION! BE AWARE! THIS IS AN IMPORTANT SAFETY INSTRUCTION!

Read, understand and follow these safety instructions. Failure to follow these safety instructions may result in injury or death.

DANGER

Immediate hazards which, if not avoided, WILL result in serious personal injury or death.

WARNING

Hazards or unsafe practices which, if not avoided, COULD result in serious personal injury or death.

CAUTION

Hazards or unsafe practices which, if not avoided, COULD result in minor personal injury or property damage.

RETAIN SAFETY INFORMATION



This manual should be read and understood by all personnel who operate the Ratchet Knockout Set. Failure to understand how to safely operate this unit could result in injury or death. This unit should only be operated by qualified personnel.



IMPORTANT SAFETY INFORMATION

Follow ALL safety information provided by the manufacturer.

⚠ DANGER

NEVER use the Knockout Set or any of its components near live circuits.

⚠ WARNING

ALWAYS thread the punch COMPLETELY onto the draw bolt to avoid thread failure. ALL punch threads must be completely engaged with the draw bolt.

⚠ WARNING

Hand pressure is sufficient to complete the punching process. NEVER attempt to apply additional pressure to the ratchet handle. Do NOT use a cheater bar. If hand pressure is not sufficient to complete the punching process, disassemble the set up and determine the cause before continuing.

⚠ WARNING

NEVER attempt to exceed the punching capacity (hole diameter or material thickness) of this knockout set. Doing so may cause component failure and possibly serious injury.

⚠ WARNING

NEVER use this knockout set or any of its components except for its intended purpose.

⚠ WARNING

Be careful as hole punching process is completed. The punching assembly (punch, die and draw bolt) can fall as the slug breaks free from the hole.

⚠ WARNING

Be careful of your footing and balance during the punching process. Make sure to have total control of your balance as the slug breaks free from the hole at the end of the punching process.

⚠ CAUTION

ALWAYS inspect every component of the punch set-up including the ratchet, punch, die, draw bolt before each use. Replace any worn or defective parts. NEVER use dull punches.

⚠ CAUTION

NEVER use any component that has worn or damaged threads.

⚠ CAUTION

ALWAYS check to ensure all components are properly assembled before punching.

⚠ CAUTION

New punches are sharp. Be careful when handling them.

⚠ CAUTION

ALWAYS wear safety glasses when punching.

SPECIFICATIONS

Model No.	157PM
Overall Dimensions	14" × 12" × 3½"
Hole Size	1/2" to 2" <i>conduit size holes</i>
Weight	9 lbs.
Capacity	10 gauge (.134 in.) mild steel maximum

NOTE: Piece Maker™ punches and dies are designed to split the slug into two pieces for easy removal after punch completion.

OPERATING INSTRUCTIONS

NOTE: Lubricate draw bolt threads and punch cutting edges before use.

1. Match the punch, die and draw bolt for the size hole to be punched.
2. After marking the hole location, drill a hole approximately 1/32" to 1/16" larger than the draw bolt being used.

NOTE: Piece Maker™ punches and dies are designed to split the slug into two pieces for easy removal after punch completion.

3. Place the die on the draw bolt with the open end of the die facing the material to be punched. Insert the draw bolt through the hole drilled in Step 2. Thread the punch onto the draw bolt until snug against the material. The punch cutting edges should face the material to be punched. (See FIGURES 1, 2, and 3).

NOTE: Punch and die MUST be the same size.

<i>use Draw Bolt</i>	<i>with Punch & Die</i>
#1557	1/2" only
#1558	3/4" thru 2"

4. Place the ratcheting wrench (#1556) on the hex head of the draw bolt and turn **CLOCKWISE** until the material is punched.

⚠ WARNING

Be careful as hole punch process is completed. The punching assembly (punch, die and draw bolt) can fall as the slug breaks free from the hole.

⚠ WARNING

Be careful of your footing and balance during the punching process. Make sure to have total control of your balance as the slug breaks free from the hole at the end of the punching process.

5. When punch is completed, disassemble the set-up by holding the hex head of the draw bolt and turning the punch **COUNTER-CLOCKWISE**. Tip the die and the split slug should fall freely from the die.

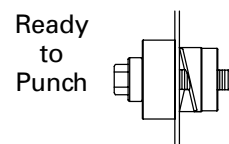
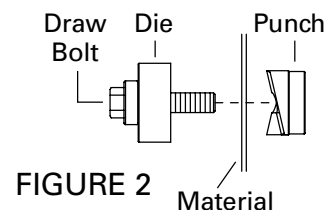
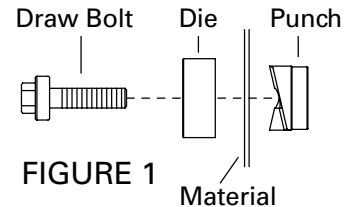

PARTS LIST

ITEM #	PART#	DESCRIPTION
1	1556	1" RATCHET WRENCH
2	1557	3/8" DRAW BOLT
3	1558	3/4" DRAW BOLT
4	1524	1/2" PIECE MAKER™ PUNCH
4	1525	1/2" DIE
5	1526	3/4" PIECE MAKER™ PUNCH
5	1527	3/4" DIE
6	1528	1" PIECE MAKER™ PUNCH
6	1529	1" DIE
7	1530	1 1/4" PIECE MAKER™ PUNCH
7	1531	1 1/4" DIE
8	1532	1 1/2" PIECE MAKER™ PUNCH
8	1533	1 1/2" DIE
9	1534	2" PIECE MAKER™ PUNCH
9	1535	2" DIE
10	157PC	PLASTIC CASE

