

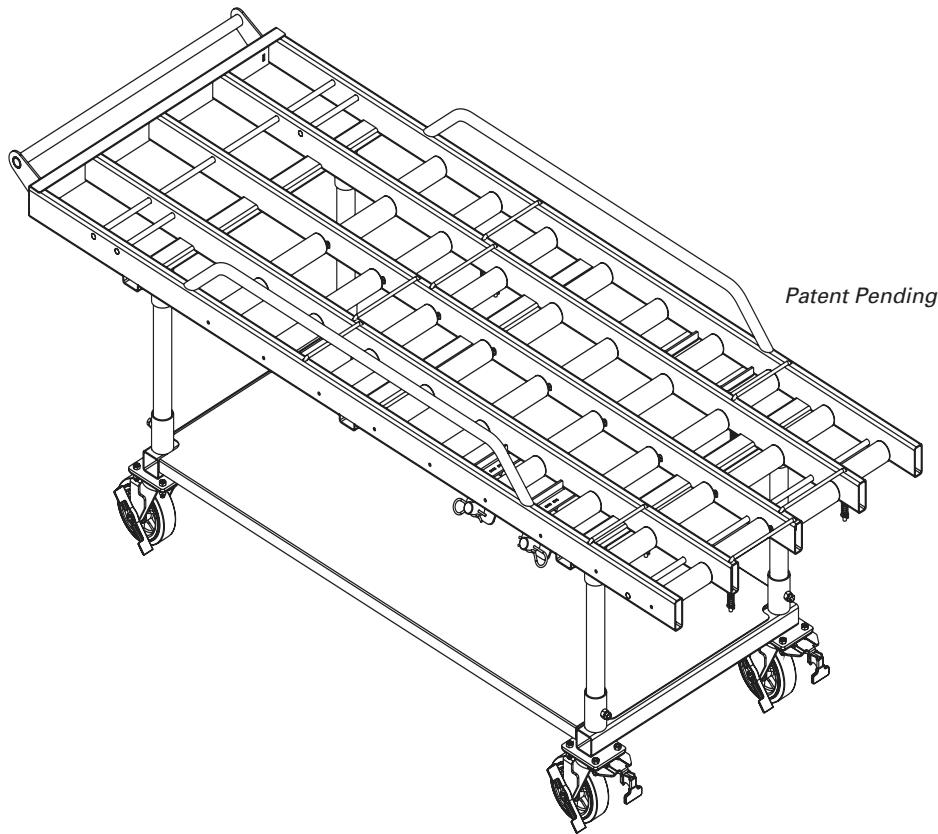

# **Current Tools**

FOR THE PROFESSIONAL ELECTRICIAN

## **Current Tools™ Model 282 Transfer Cart for 2½" to 4" hydraulic bender shoes, follow bars and saddles**



## **Assembly, Operating, Safety and Parts Manual**

10/2021



**Read and understand this material before assembling, operating or servicing the 282 Transfer Cart. Failure to understand how to safely assemble and operate this equipment may result in serious injury or death.**

This manual is free of charge. All personnel who assemble, operate or service this equipment should have a copy of this manual and read and understand its contents. To request a copy, call or write to the address below. All information, specifications and product designs may change due to design improvements or updates and are subject to change without notice. Current Tools does not assume any liability for damages resulting from misuse or incorrect application of its products.

**CURRENT TOOLS • P. O. BOX 17026 GREENVILLE, SC 29606  
800.230.5421 or 864.721.4230 • FAX 864.721.4232  
[www.currenttools.com](http://www.currenttools.com)**



## TABLE OF CONTENTS — 282 TRANSFER CART

<b><i>Safety Alerts .....</i></b>	<b><i>2</i></b>
<b><i>Important Safety Information .....</i></b>	<b><i>3</i></b>
<b><i>Specifications and Features .....</i></b>	<b><i>4</i></b>
<b><i>Assembly and Operating Instructions .....</i></b>	<b><i>5-8</i></b>
<b><i>Exploded View and Parts List .....</i></b>	<b><i>9</i></b>

### RETAIN SAFETY INFORMATION



This manual should be read and understood by all personnel who assemble, operate or service this Transfer Cart. Failure to understand how to safely assemble and operate this unit could result in injury or death. This Transfer Cart and hydraulic bender should only be assembled, operated and serviced by qualified personnel.



## SAFETY ALERTS



### Safety Alert Symbol

THIS SAFETY SYMBOL is used to call your attention to instructions that concern your personal safety. It means: ATTENTION! BE AWARE! THIS IS AN IMPORTANT SAFETY INSTRUCTION!

Read, understand and follow these safety instructions. Failure to follow these safety instructions may result in injury or death.

### DANGER

Immediate hazards which, if not avoided, WILL result in serious personal injury or death.

### WARNING

Hazards or unsafe practices which, if not avoided, COULD result in serious personal injury or death.

### CAUTION

Hazards or unsafe practices which, if not avoided, COULD result in minor personal injury or property damage.



## IMPORTANT SAFETY INFORMATION

- ⚠ WARNING** ALWAYS inspect the cart before operating. Replace any damaged, missing or worn parts. Check for alignment of moving parts, binding of moving parts, breakage of parts and any other conditions that may affect its operation.
- ⚠ WARNING** DO NOT lift cart while loaded.
- ⚠ WARNING** ONLY lift the cart from underneath the cart base, NEVER lift the cart by the roller bed.
- ⚠ WARNING** ALWAYS unload the cart prior to transporting.
- ⚠ WARNING** NEVER alter this equipment. Doing so will void the warranty.
- ⚠ WARNING** ALWAYS use appropriate bending shoe, follow bar and saddle for the size conduit to be bent.
- ⚠ WARNING** ALWAYS keep shoe group components under control when rolling or using the transfer cart.
- ⚠ WARNING** ALWAYS keep the gates closed on all rows when rolling the cart and when the rows are not in use.
- ⚠ WARNING** ONLY roll on a firm, flat, smooth surface.
- ⚠ WARNING** ALWAYS keep the path of the shoe group components clear of obstructions.
- ⚠ WARNING** ALWAYS load or unload the bender components onto or off of their designated locations on the cart.
- ⚠ WARNING** Some hydraulic bender components exceed 50 lbs. and will require more than one person to lift, transport and assemble.
- ⚠ CAUTION** Only use the transfer cart for its intended purpose as specified in this manual.
- ⚠ CAUTION** ALWAYS keep hands and feet away from pinch points.
- ⚠ CAUTION** ALWAYS wear approved safety glasses.
- ⚠ CAUTION** ALWAYS wear proper apparel. Do not wear loose clothing, neckties, rings, bracelets, or other jewelry which may get caught in moving parts. Non-slip footwear is recommended. Wear protective hair covering to contain long hair.
- ⚠ CAUTION** ALWAYS keep children away. All visitors should remain a safe distance from work area.
- ⚠ CAUTION** NEVER sit, ride or stand on the transfer cart.
- ⚠ CAUTION** ONLY use with shoe group components from the Current Tools Model #254 Hydraulic Bender OR Greenlee® Model #881 CamTrack® Hydraulic Bender\*

*Greenlee® and CamTrack® are registered trademarks of Greenlee Tools Inc., which has no affiliation with Current Tools.*

## SPECIFICATIONS

<b>model no.</b>	— 282
<b>width</b>	— 31¾"
<b>length</b>	— 87"
<b>height</b>	— 36"
<b>weight</b>	— 320 lbs. – cart only
<b>maximum weight cap.</b>	— Roller Bed — 650 lbs. Lower Shelf — 150 lbs.
<b>shoe group cap.</b>	— 2½" shoe, follow bar, saddle 3" shoe, follow bar, saddle 3½" shoe, follow bar, saddle 4" shoe, follow bar, saddle

## FEATURES

- Easy mobility of 2½" thru 4" shoe groups (shoes, follow bars, saddles)
- Reduced lifting of heavy components lessens fatigue and chance of injury
- Extra storage tray on the bottom of the cart base
- Ability to adjust cart height
- Component locations clearly marked for easy identification
- For use with Current Tools Model #254 Hydraulic Bender shoe group components (shoe, follow bar, saddle). Greenlee® Model #881 CamTrack® shoe group components will fit the Transfer Cart as well.
- Standard legs provide correct height for use with Current Tools Model #281 Bending Table or Greenlee Model #1813 Bending Table

*Greenlee® and CamTrack® are registered trademarks of Greenlee Tools Inc., which has no affiliation with Current Tools.*



## ASSEMBLY AND OPERATING INSTRUCTIONS

### ASSEMBLING CART

1. Using the hardware provided, attach the casters to the caster plates on the four corners of the cart base. (See Figure 5).

**NOTE: ONLY three of item #s 15 thru 18 are used per caster**

**NOTE: There are two swivel locks (Item #4) provided and should be installed on the front of the cart**

2. Insert the four legs into the receiver tubes at the four corners of the cart base. (See Figure 5).

**NOTE:** To adjust the height of the cart, the user can substitute the legs with four pieces of 1 1/4" Rigid conduit cut to the desired length. All legs must be the same length.

3. With a helper, lift the roller bed and place it on top of the four legs installed in Step 2. Ensure that the legs are fully inserted into the four receiver tubes on the bottom of the roller bed. (See Figure 5).

4. Install the bolts (8) into the receiver tube threaded nuts and tighten against the legs. (See Figure 5).

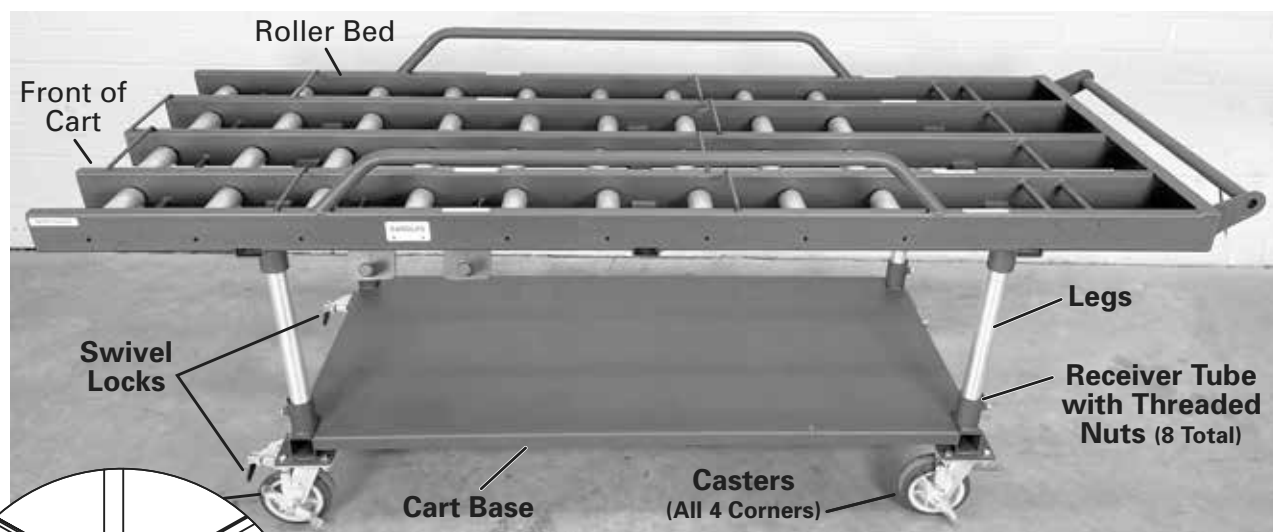
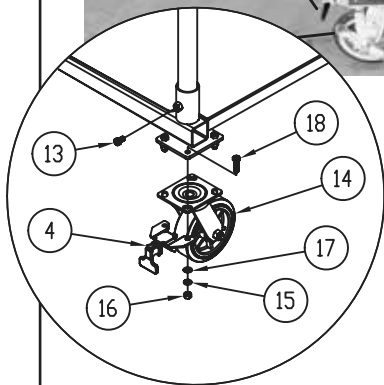

Figure 5



## PARTS LIST – CASTERS AND HARDWARE

ITEM #	PART #	DESCRIPTION	QTY.
4	282-001	SWIVEL LOCK	2
13	503-32	BOLT – HEX HEAD CAP GR5 ZINC (3/8-16 × 5/8)	8
14	513-001	CASTER	4
15	452-27	3/8 LOCK WASHER	12
16	452-28	3/8 HEX NUT	12
17	506-3	WASHER – FLAT 3/8 (USS) ZINC	12
18	281-2D	BOLT – HEX HEAD CAP GR5 ZINC (3/8-16 × 1.25)	12



## ASSEMBLY AND OPERATING INSTRUCTIONS — CONTINUED

5. The gates on the roller bed are installed at the factory. Ensure that all eight gates (two per row) are in place and operable. To open, lift the gate from the spring side and rotate towards the front of the cart. To secure, return the gate to the retainer hole. (See Figure 6).

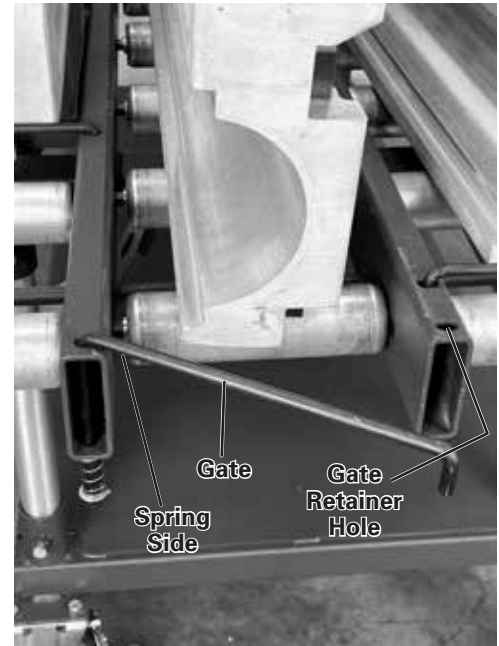

Figure 6

### LOADING CART

**NOTE: Engage the brake on all casters before loading or removing components**

1. A set of pins (two per sides) are mounted under the roller bed to store the four saddles. Pull the spring clips out of the mounting holes and slide the saddles onto the pins with the “u” of the saddle under the roller bed. Replace the spring clips to secure the saddles. (See Figure 6A).



Figure 6A



## ASSEMBLY AND OPERATING INSTRUCTIONS — CONTINUED

2. Decals indicate correct placement for all components. To load the shoes and follow bars onto the cart, start with the 3 ½" and 4" inner rows of the cart. (See Figure 7). Lift the gate from the spring side and rotate towards the front of the cart.

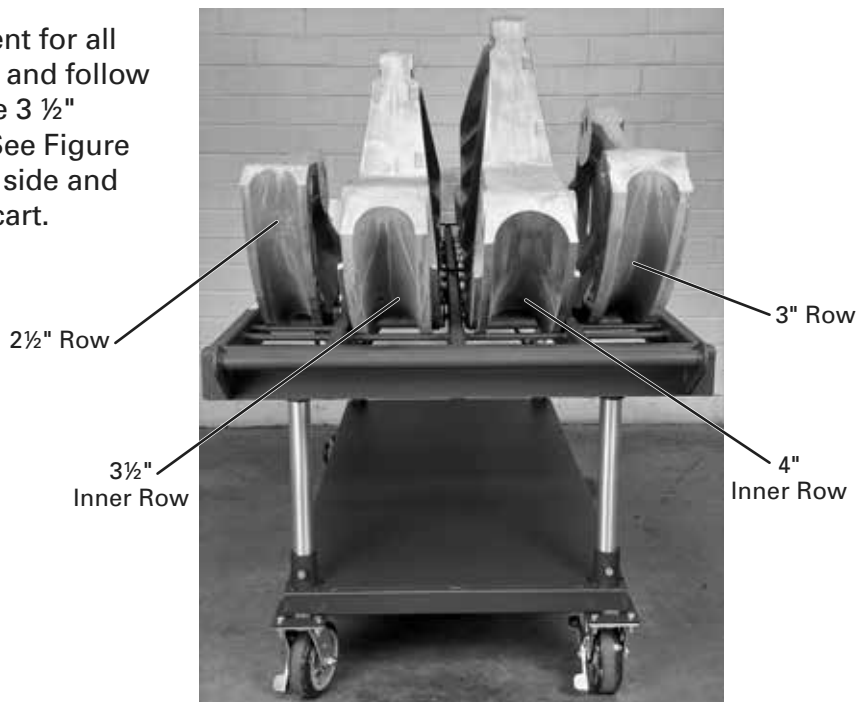

Figure 7

3. Place the shoe in the correct row of the roller bed with the saddle mounting hole facing the rear of the cart and slide the shoe until it touches the shoe stop. **NOTE: To sit in the correct position, the shoe must touch the shoe stop.** (See Figure 7A). Return the rear gate in front of the shoe to its closed position. Next, place the corresponding follow bar on the roller bed with the “ears” of the follow bar facing upward and the end of the follow bar marked “START” facing the shoe. Roll the follow bar towards the bending shoe until it reaches the rear gate. Return the front gate to its closed position. Repeat this process for the remaining shoes and follow bars.

**⚠ WARNING** ALWAYS keep the gates closed on all rows when rolling the cart.

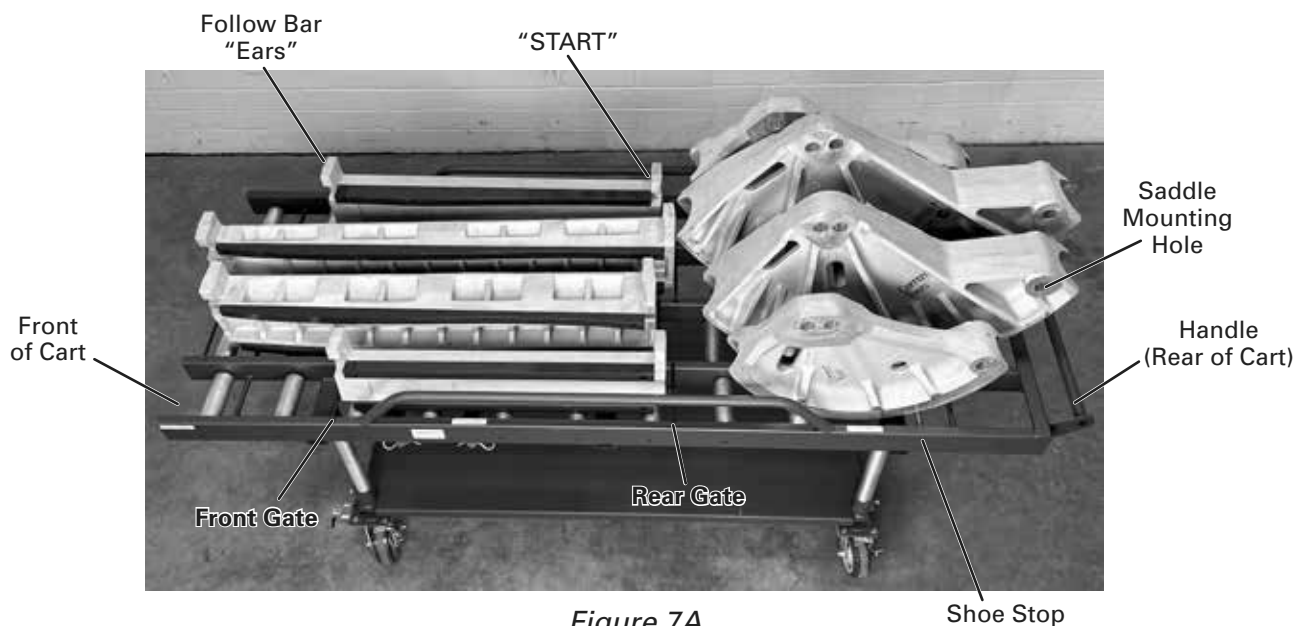

Figure 7A



### OPERATING CART

1. Release the brakes on all the casters and roll the cart to your bender.
2. Line up the row with the follow bar and shoe you will be using with the Current Tools Model #254 Hydraulic Bender mounted on the 281 Bending Table. (See Figure 8)
3. Engage the brake on all casters.
4. Load your follow bar, shoe and saddle by following the bender assembly and mounting instructions located in your bending manual to complete the set up of your bender for the size conduit you will be bending.

5. Prior to making a bend, disengage the caster brakes and roll the cart away from the bender.
6. After bending is complete, follow the cart loading instructions to return the shoe, follow bar and saddle to their storage positions on the cart.

NOTE: Swivel locks are provided on the front casters to help with maneuvering the cart.

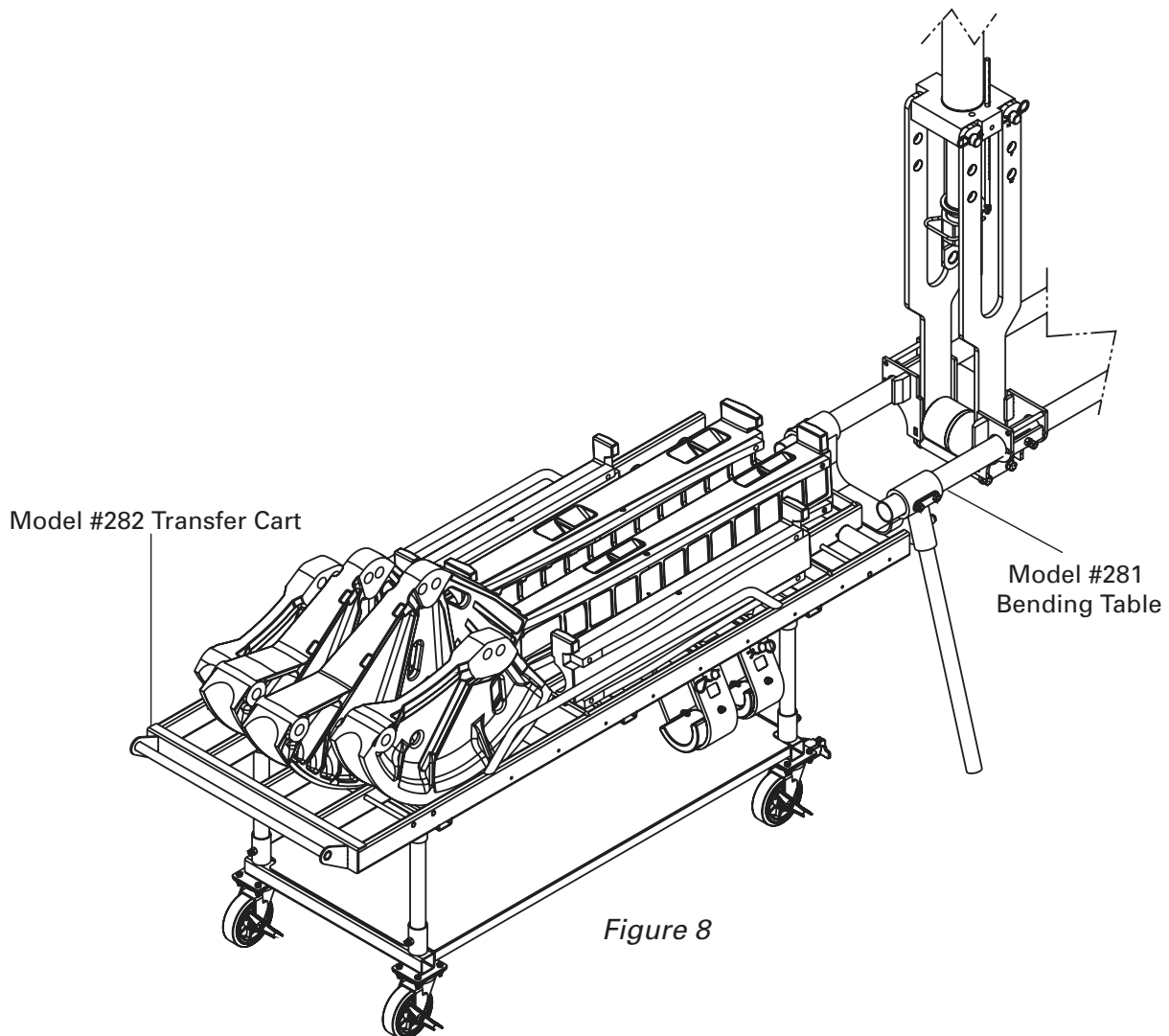
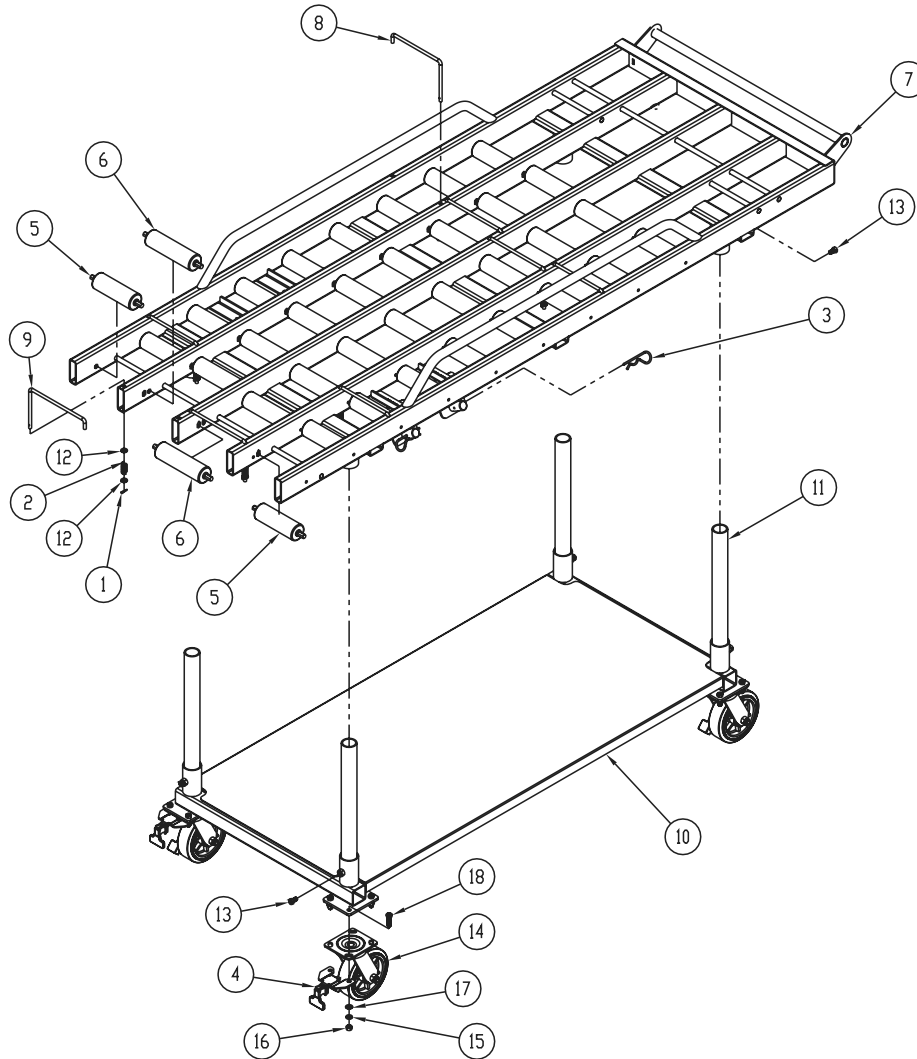

Figure 8



# EXPLODED VIEW



# PARTS LIST

ITEM #	PART #	DESCRIPTION	QTY.
1	88-2	PIN – COTTER (1/8 x 1/2)	8
2	100-011	SPRING – GATE	8
3	254-006	SPRING CLIP	4
4	282-001	SWIVEL LOCK	2
5	282-002	CONVEYOR ROLLER – 7 9/16" LONG	18
6	282-003	CONVEYOR ROLLER – 8 9/16" LONG	18
7	282-106	ROLLER BED	1
8	282-116	GATE, OUTER	4
9	282-117	GATE, INNER	4
10	282-120	BASE – CART	1
11	282-123	LEG, STANDARD	4
12	412-12	WASHER – FLAT SAE ZINC (5/16)	16
13	503-32	BOLT – HEX HEAD CAP GR5 ZINC (3/8-16 x 5/8)	8
14	513-001	CASTER	4
15	452-27	3/8 LOCK WASHER	12
16	452-28	3/8 HEX NUT	12
17	506-3	WASHER – FLAT 3/8 (USS) ZINC	12
18	281-2D	BOLT – HEX HEAD CAP GR5 ZINC (3/8-16 x 1.25)	12