



Current Tools

FOR THE PROFESSIONAL ELECTRICIAN

Model 504 Reel Dolly

CAPACITY:

- Maximum 300 lbs.
- Holds reels of cable up to 20" wide and 40" diameter.

CAUTION

Only roll on a firm, flat, smooth surface.

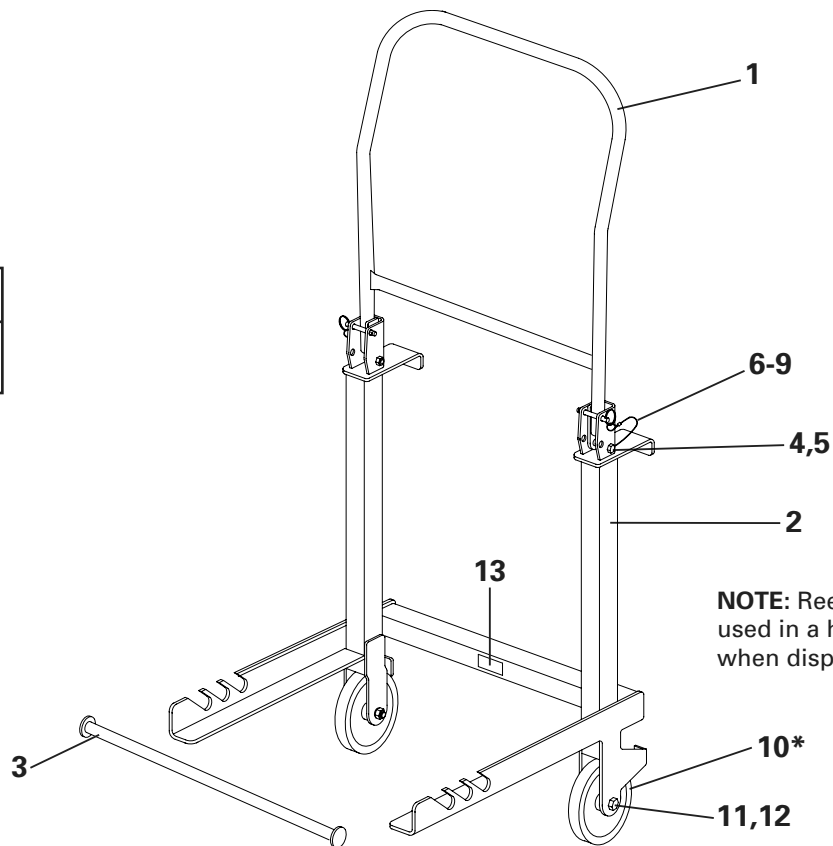

NOTE: Reel Dolly must be used in a horizontal position when dispensing wire.

INSTRUCTION SHEET AND PARTS LIST

PARTS LIST — 504 REEL DOLLY

ITEM#	PART#	QTY	DESCRIPTION	ITEM#	PART#	QTY	DESCRIPTION
1	504-523	1	HANDLE	8	670-6	4	CABLE STOP
2	504-WELDMENT	1	FRAME	9	670-6A	2	CABLE FERRULE
3	504-199	1	RACK BAR	10*	500-001	2	WHEEL
4	281-1E	2	SCREW, HEX HEAD CAP, 1/2-13x3"	11	504-4	2	SCREW, HEX HEAD CAP, 5/8-11x3 1/2
5	333-7	2	NUT, HEX, 1/2-13, NYLON INSERT	12	2-1401-4	2	NUT, HEX, 5/8-11 NYLON INSERT
6	504-23	2	QUICK RELEASE PIN	13	504-DECAL	1	DECAL
7	33-27	2	STRANDED CABLE				

*For Model #504 Reel Dollies purchased prior to 2022, the replacement wheel Part Number is 504-3.



Read and understand this material before operating the Reel Dolly. Failure to understand how to safely operate this Reel Dolly may result in injury or property damage.

This manual is free of charge. All personnel who operate the Reel Dolly should have a copy of this manual and read and understand its contents. To request a copy, call, write to the address below or visit our website. All information, specifications and product designs may change due to design improvements or updates and are subject to change without notice. Current Tools does not assume any liability for damages resulting from misuse or incorrect application of its products.

CURRENT TOOLS • P. O. BOX 17026 GREENVILLE, SC 29606
800.230.5421 or 864.721.4230 • FAX 864.721.4232 • www.currenttools.com