



Current Tools

FOR THE PROFESSIONAL ELECTRICIAN

Model 505 Conduit Rack

CAPACITY:

Maximum 1000 lbs.
Evenly distributed.

CAUTION

Only roll on a firm,
flat, smooth surface.

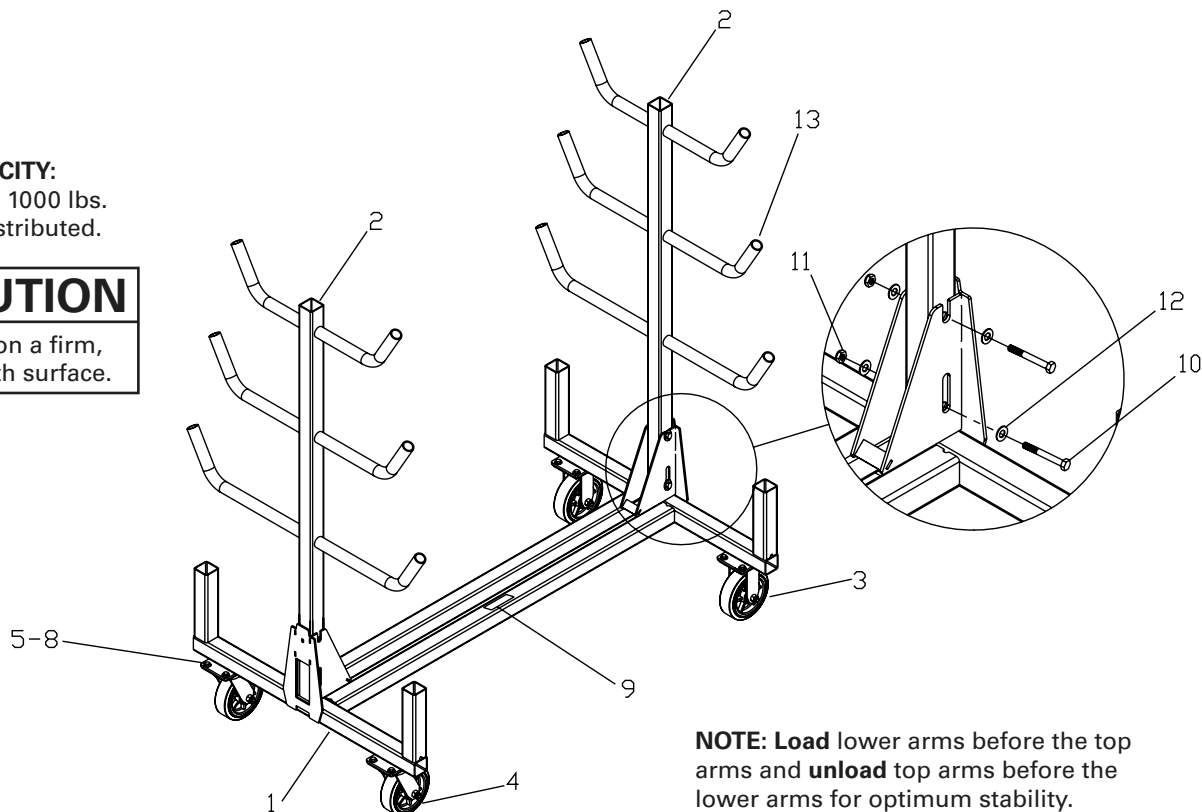

NOTE: Load lower arms before the top arms and **unload** top arms before the lower arms for optimum stability.

INSTRUCTION SHEET AND PARTS LIST

PARTS LIST — 505 CONDUIT RACK

ITEM#	PART#	QTY	DESCRIPTION
1	505-245	1	BASE
2	505-246	2	ARM
3	506-2	2	CASTER, RIGID
4	506-1	2	CASTER, SWIVEL
5	281-2D	16	SCREW, HEX HEAD CAP 3/8-16 x 1-1/4"
6	506-3	16	WASHER, FLAT
7	452-27	16	WASHER, LOCK

ITEM#	PART#	QTY	DESCRIPTION
8	452-28	16	NUT, HEX, 3/8-16
9	505-10	1	DECAL
10	66-67	4	SCREW, HEX HEAD CAP 1/2-13 x 3/4"
11	281-1J	4	NUT, HEX 1/2-13 THIN NYLON INSERT
12	451-25	8	WASHER, FLAT
13	505-18	12	PLUG, PLASTIC

07/2022



Read and understand this material before operating the Conduit Rack. Failure to understand how to safely operate this Conduit Rack may result in injury or property damage.

This manual is free of charge. All personnel who operate the Conduit Rack should have a copy of this manual and read and understand its contents. To request a copy, call, write to the address below or visit our website. All information, specifications and product designs may change due to design improvements or updates and are subject to change without notice. Current Tools does not assume any liability for damages resulting from misuse or incorrect application of its products.

CURRENT TOOLS • P. O. BOX 17026 GREENVILLE, SC 29606
800.230.5421 or 864.721.4230 • FAX 864.721.4232 • www.currenttools.com