

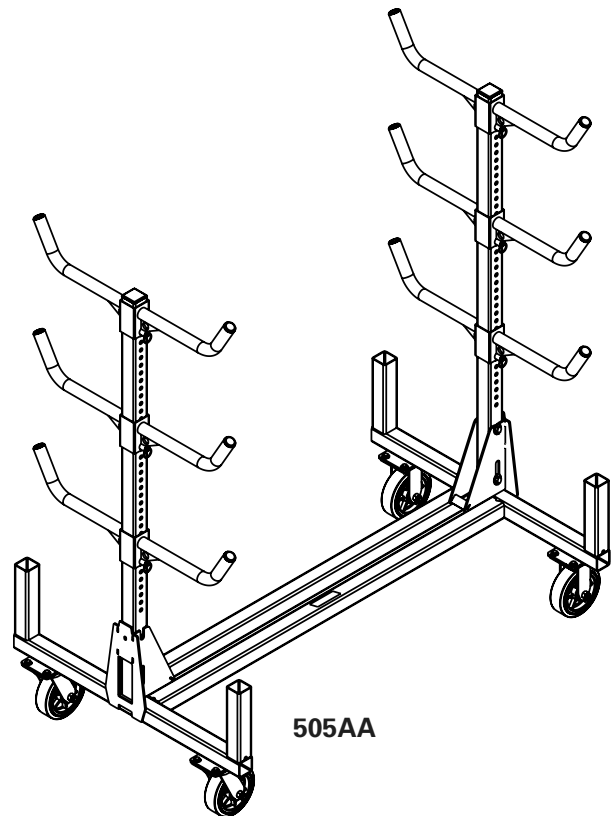

# ***Current Tools***

**FOR THE PROFESSIONAL ELECTRICIAN**

## **Model 505AA Conduit Rack with Adjustable Arms AND Model 505MAA Conduit Rack with Adjustable Arms and Mesh Base**

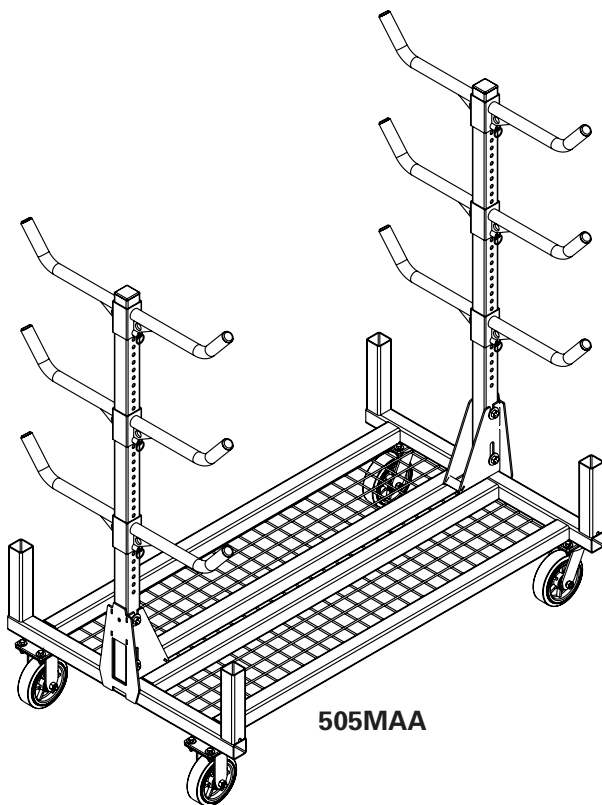

## **INSTRUCTION SHEET AND PARTS LIST**

5/2018 Rev. 1



**Read and understand this material before operating the Adjustable Arm Conduit Rack. Failure to understand how to safely operate this Conduit Rack may result in injury or property damage.**

This manual is free of charge. All personnel who operate the Adjustable Arm Conduit Rack should have a copy of this manual and read and understand its contents. To request a copy, call, write to the address below, or visit our website. All information, specifications and product designs may change due to design improvements or updates and are subject to change without notice. Current Tools does not assume any liability for damages resulting from misuse or incorrect application of its products.

**CURRENT TOOLS • P. O. BOX 17026 GREENVILLE, SC 29606  
800.230.5421 or 864.721.4230 • FAX 864.721.4232 • [www.currenttools.com](http://www.currenttools.com)**

# SPECIFICATIONS – 505AA & 505MAA

<b>Model No.</b>	505AA	505MAA
<b>Dimensions</b>	58 1/2" L x 34" W x 61" H	58 1/2" L x 34" W x 61" H
<b>Weight Capacity</b>	1,000 lbs. evenly distributed 125 lbs. per adjustable arm	1,000 lbs. evenly distributed 125 lbs. per adjustable arm
<b>Weight</b>	113 lbs.	119 lbs

## EXPLODED VIEW AND PARTS LIST

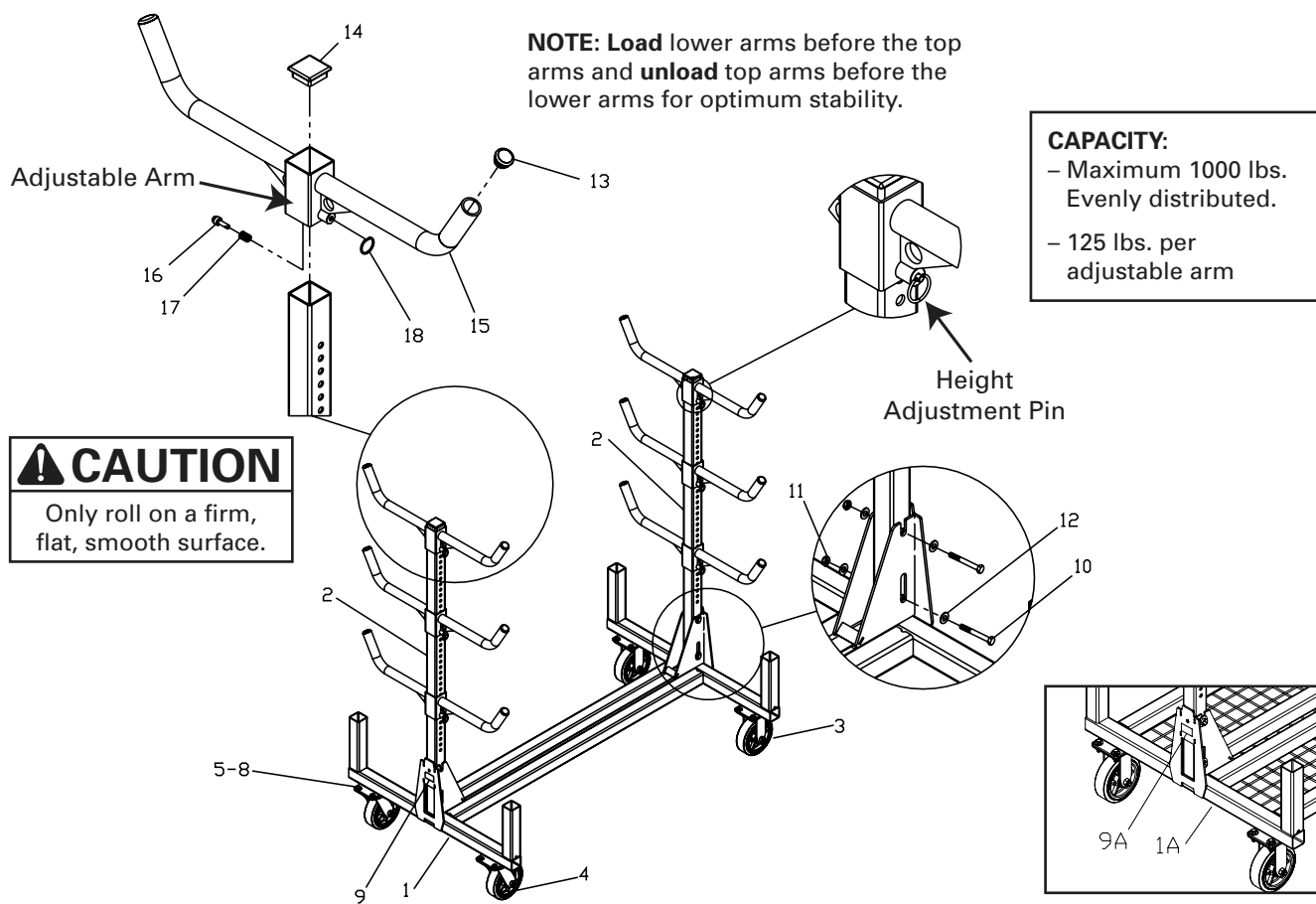

### PARTS LIST — 505AA AND 505MAA CONDUIT RACK

ITEM#	PART#	QTY	DESCRIPTION	ITEM#	PART#	QTY	DESCRIPTION
1	505-245	1	BASE	9A	505MAA-DECAL	1	DECAL – 505MAA
1A	505M-102	1	BASE WITH MESH	10	66-67	4	SCREW, HEX HEAD CAP 1/2-13 x 3/4"
2	505AA-115	2	TUBE – CENTER	11	281-1J	4	NUT, HEX 1/2-13 THIN NYLON INSERT
3	506-2	2	CASTER, RIGID	12	451-25	8	WASHER, FLAT
4	506-1	2	CASTER, SWIVEL	13	505-18	12	PLUG, PLASTIC
5	281-2D	16	SCREW, HEX HEAD CAP 3/8-16 x 1-1/4"	14	752-107	2	CAP, PLASTIC
6	506-3	16	WASHER, FLAT	15	505AA-101	6	ARM, ADJUSTABLE
7	452-27	16	WASHER, LOCK	16	505AA-113	6	PIN
8	452-28	16	NUT, HEX, 3/8-16	17	505AA-002	6	SPRING
9	505AA-DECAL	1	DECAL	18	8099-3	6	RING

**CURRENT TOOLS • P. O. BOX 17026 GREENVILLE, SC 29606**

**800.230.5421 or 864.721.4230 • FAX 864.721.4232 • [www.currenttools.com](http://www.currenttools.com)**