

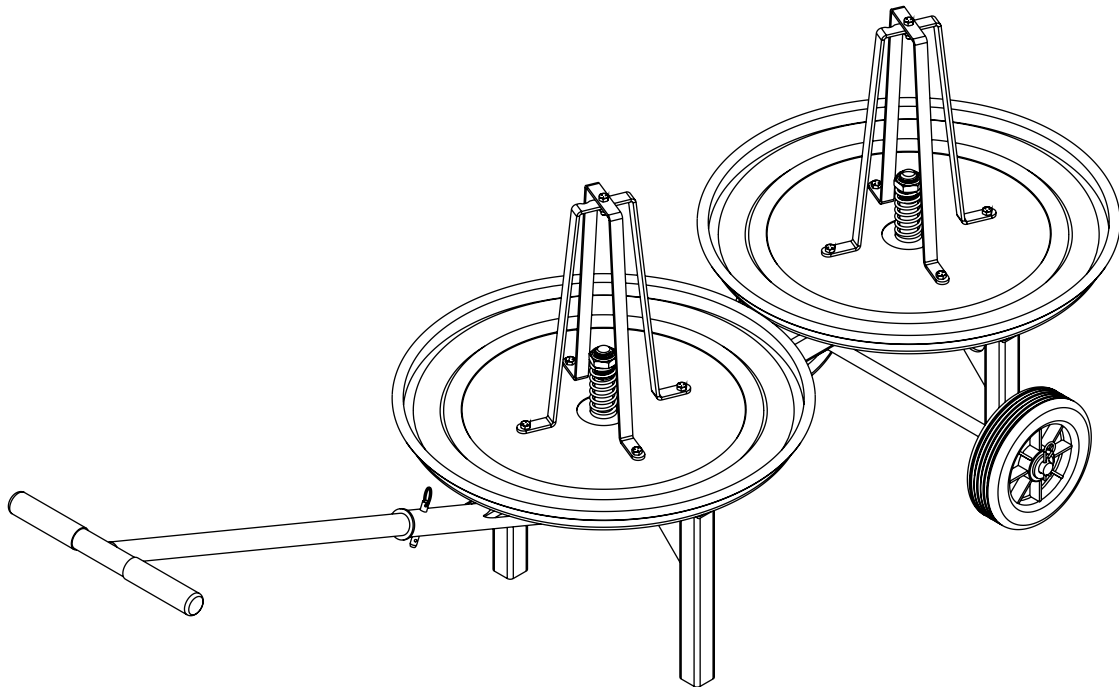

Current Tools

FOR THE PROFESSIONAL ELECTRICIAN

Current Tools™ Model 509DMC Dual Mobile Armored Cable Dispenser



Operating, Safety, and Parts Manual

08/22



Read and understand this material before operating the Cable Dispenser. Failure to understand how to safely operate this unit may result in injury or property damage.

This manual is free of charge. All personnel who operate the Cable Dispenser should have a copy of this manual and read and understand its contents. To request a copy, call or write to the address below. All information, specifications and product designs may change due to design improvements or updates and are subject to change without notice. Current Tools does not assume any liability for damages resulting from misuse or incorrect application of its products.

**CURRENTTOOLS • P. O. BOX 17026 GREENVILLE, SC 29606
800.230.5421 or 864-721-4230 • FAX 864-721-4232
www.currenttools.com**



TABLE OF CONTENTS

Important Safety Information	2
Specifications	2
Features	3
Operating Instructions	3
Exploded View and Parts Lists	4,5

RETAIN SAFETY INFORMATION



This manual should be read and understood by all personnel who operate the Cable Dispenser. Failure to understand how to safely operate this unit could result in injury or property damage. This unit should only be operated by qualified personnel.



IMPORTANT SAFETY INFORMATION

Follow ALL safety information provided by the manufacturer.

▲ CAUTION

Do NOT stand on the Cable Dispenser. It may become unstable and cause injury or damage to unit.

▲ CAUTION

Do NOT overload Cable Dispenser. Maximum dispensing capacity is 50 lbs. per turntable. (100 lbs. total).

▲ CAUTION

ONLY transport cable reels to be dispensed on the 509DMC Cable Dispenser. Transporting other loads may damage unit.

▲ CAUTION

Stay CLEAR of Cable Dispenser while in use.



SPECIFICATIONS

Model No.	509DMC
Dispensing Capacity per Turntable	250' — one coil 14/2, 14/3, 12/2 or 12/3 MC cable or 1 coil unboxed Romex®* (50 lbs. max.) NOTE: TRANSPORT ARMORED CABLE OR UNBOXED ROMEX® UP TO 50 LBS. MAXIMUM PER TURNTABLE (100 LBS. TOTAL)
Unit Weight	68 lbs.
Height	30 1/2"
Length	76 1/4"
Width	23 3/4"

*Romex is a registered trademark of Southwire Company, LLC.

FEATURES

- Sturdy steel construction for rugged use.
- Convenient T-handle and durable wheels for easy mobility.
- T-handle can be stowed on the carriage to save space during storage.
- Fits through a standard 32" doorway.
- Includes an adjustable spring to set the drag required and to prevent over-feeding.

OPERATING INSTRUCTIONS

1. Un-pin the T-handle from its stowed position on the carriage (see Figure 3) and insert it into the T-handle receiver on the end of the cart. Re-pin the handle (see Figure 3A).
 2. Place the coil of wire or cable onto the turntable with the wire or cable unwinding from the outside of the dispenser. Remove all ties or straps from the coil. (For Romex[®]*, remove from box and place onto turntable).
 3. Set the desired drag on each turntable by adjusting the hex nut at the top of the spring.
 4. Position the cart so that the wire or cable is dispensed from the side of the cart.
- NOTE: If you are only dispensing one coil of wire or cable, you can use either turntable and it can be loaded for use in either direction.

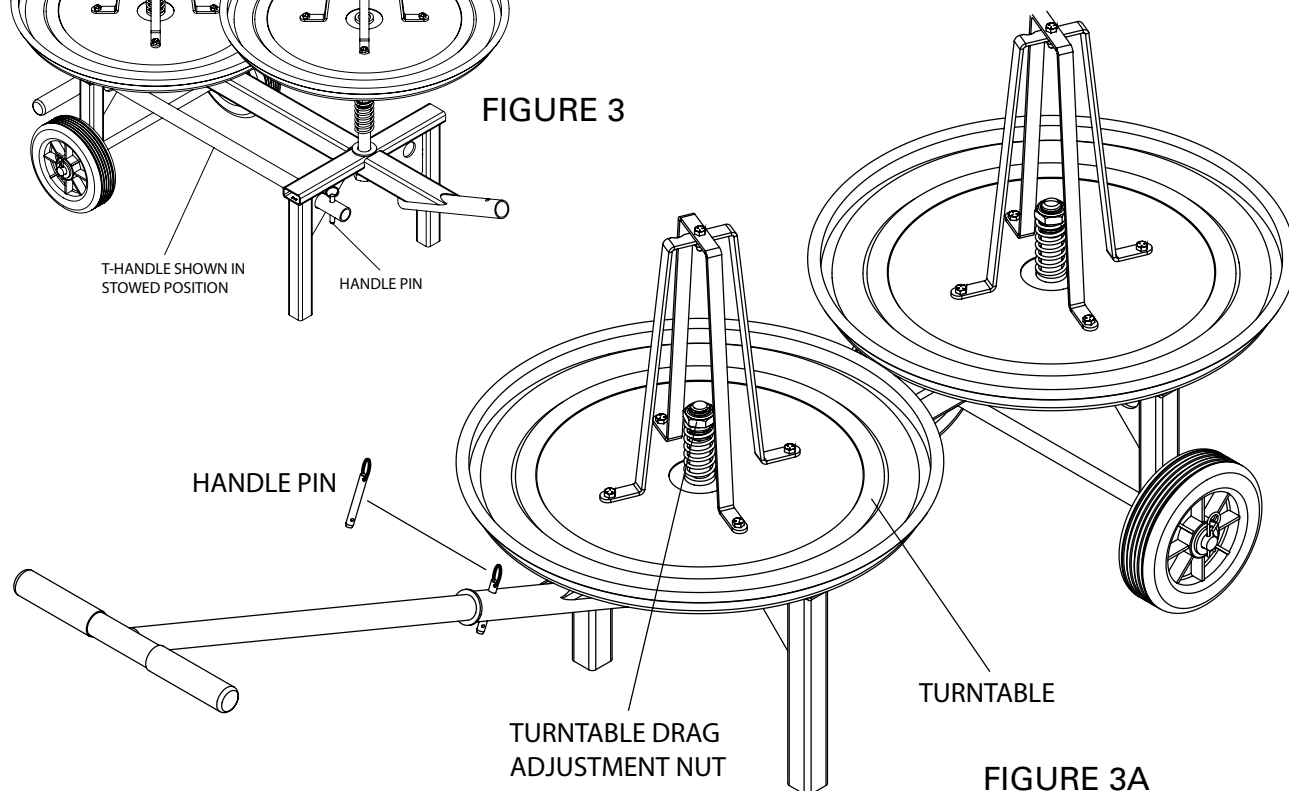
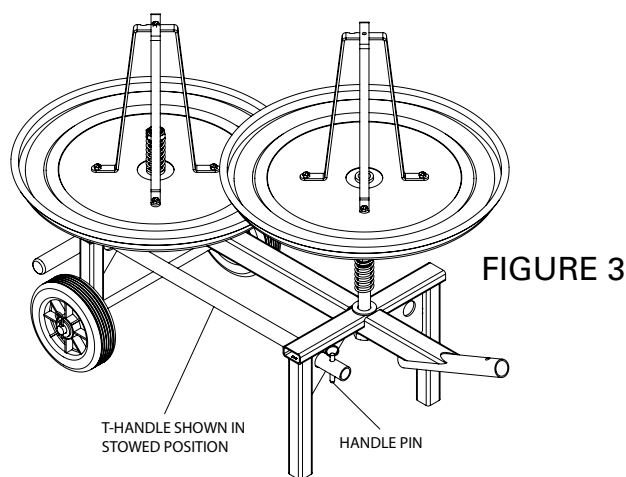

*Romex is a registered trademark of Southwire Company, LLC.

EXPLODED VIEW — FRAME

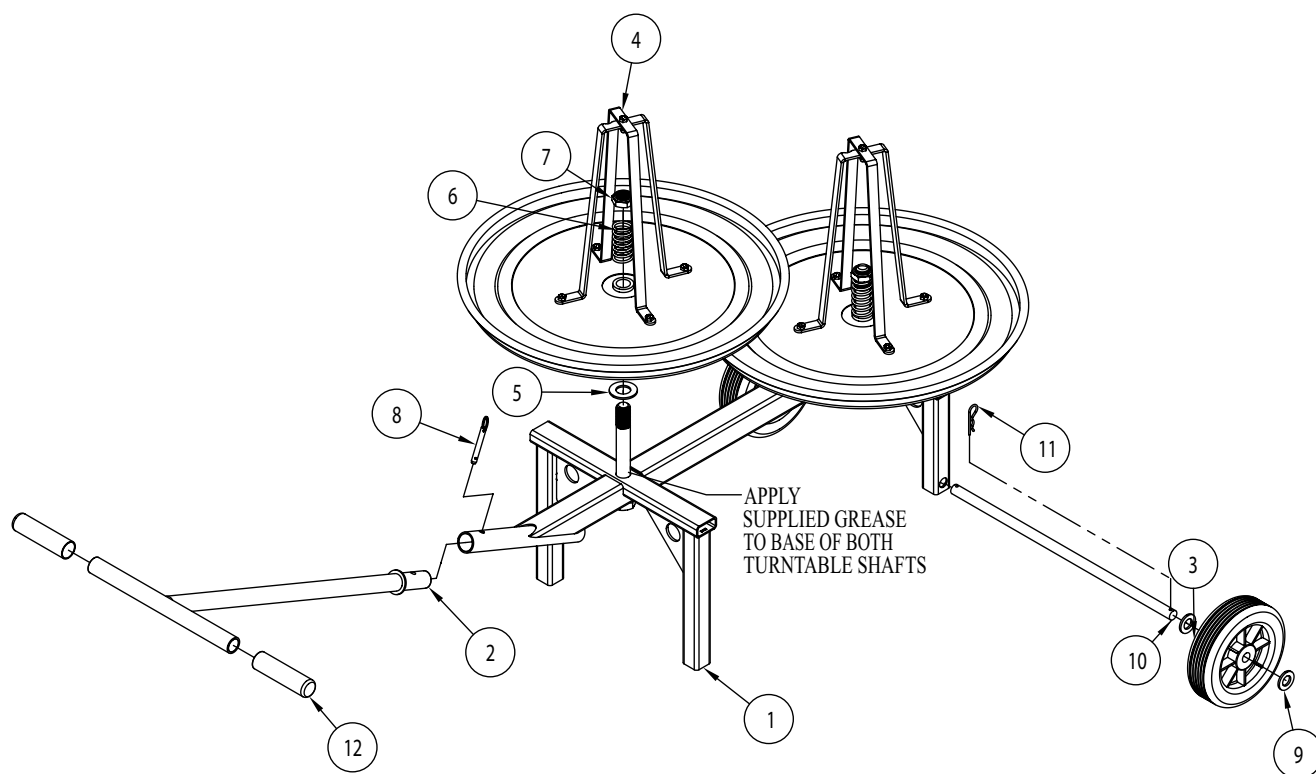

PARTS LIST — FRAME

ITEM #	PART #	DESCRIPTION	QTY.
1	509DMC-200	FRAME	1
2	509-582	HANDLE — T	1
3	510-2	8" WHEEL	2
4	509-101	TURNABLE ASSEMBLY	2
5	509-15	WASHER, THRUST	2
6	509-2	SPRING, COMPRESSION	2
7	509-3	NUT — HEX NYLON INSERT THIN (1-8)	2
8	9548-7	PIN — QUICK RELEASE 3/8 x 2-1/4"	1
9	77-017	WASHER — FLAT 3/4" (SAE)	4
10	33-967	AXLE	1
11	33-36	R CLIP	2
12	504-1	GRIP	2

EXPLODED VIEW — TURNTABLE

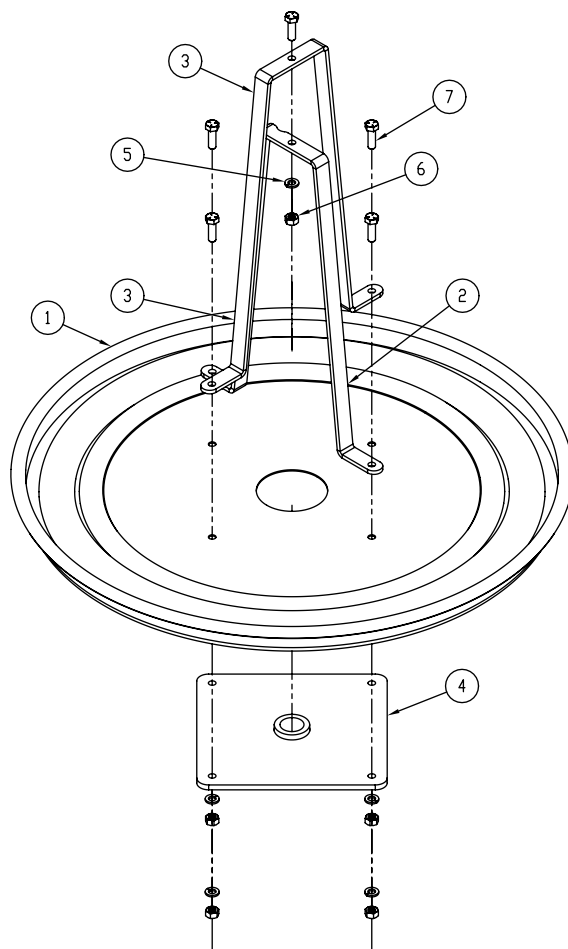

PARTS LIST — TURNTABLE

ITEM #	PART #	DESCRIPTION	QTY.
1	509-271	TURNTABLE	1
2	509-267A	STRAP — SHORT	1
3	509-267B	STRAP — LONG	1
4	509-266	MOUNTING PLATE	1
5	412-11	WASHER — LOCK MEDIUM 5/16 ZINC	5
6	412-8	NUT — HEX ZINC (5/16-18)	5
7	9544-15	SCREW — HEX HEAD CAP GR5 ZINC (5/16-18 x 1)	5