

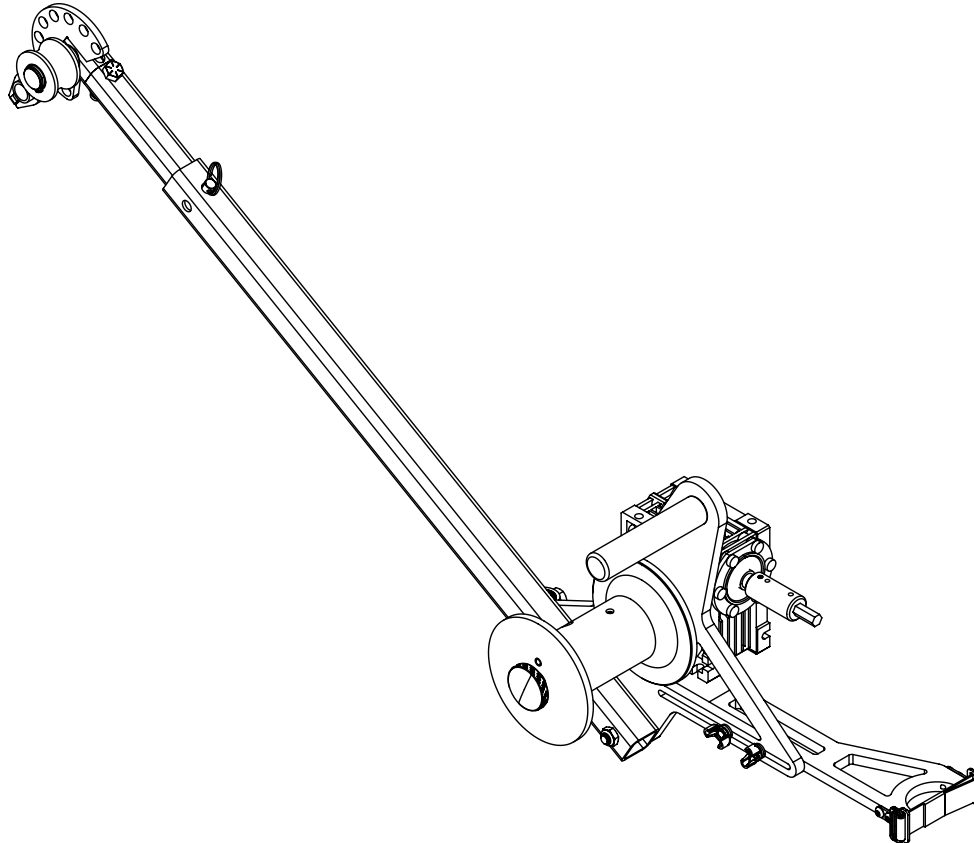

Current Tools

FOR THE PROFESSIONAL ELECTRICIAN

Model 11 High Speed Cable Puller



Operating, Maintenance, Safety and Parts Manual

6/2023



Read and understand this material before operating or servicing the Cable Puller. Failure to understand how to safely operate and service this unit may result in serious injury or death.

This manual is free of charge. All personnel who operate the Cable Puller should have a copy of this manual and read and understand its contents. To request a copy of this manual or replacement safety decals, or for technical assistance, call or write to the address below. All information, specifications and product designs may change due to design improvements or updates and are subject to change without notice. Current Tools does not assume any liability for damages resulting from misuse or incorrect application of its products.

CURRENTTOOLS • P. O. BOX 17026 GREENVILLE, SC 29606
800.230.5421 or 864.721.4230 • FAX 864.721.4232
www.currenttools.com



TABLE OF CONTENTS

<i>Safety Alerts</i>	3
<i>Important Safety Information</i>	4,5
<i>Specifications</i>	6
<i>Features</i>	6,7
<i>Set-Up and Operating Instructions</i>	8–16
<i>Common Set-Ups</i>	17
<i>Exploded View</i>	18
<i>Parts List</i>	19



Safety Alert Symbol

THIS SAFETY SYMBOL is used to call your attention to instructions that concern your personal safety. It means: **ATTENTION! BE AWARE! THIS IS AN IMPORTANT SAFETY INSTRUCTION!**

Read, understand and follow these safety instructions. Failure to follow these safety instructions may result in injury or death.

DANGER

Immediate hazards which, if not avoided, **WILL** result in serious personal injury or death.

WARNING

Hazards or unsafe practices which, if not avoided, **COULD** result in serious personal injury or death.

CAUTION

Hazards or unsafe practices which, if not avoided, **COULD** result in minor personal injury or property damage.

RETAIN SAFETY INFORMATION



This manual should be read and understood by all personnel who operate or service this Cable Puller. Failure to understand how to safely operate and service this equipment could result in injury or death. This equipment should only be operated and serviced by qualified personnel.



IMPORTANT SAFETY INFORMATION

- ⚠ DANGER** DO NOT operate cable puller in wet or damp locations.
- ⚠ DANGER** DO NOT expose to rain.
- ⚠ DANGER** DO NOT operate in an explosive atmosphere.
- ⚠ DANGER** DO NOT use near energized circuits.
- ⚠ WARNING** DO NOT use cable puller as a hoist or for lifting, supporting or transporting people or loads. Use only for its intended purpose as a cable puller.
- ⚠ WARNING** DO NOT wrap rope around any body parts. DO NOT wrap rope around wrists. Hold rope so that it may be released quickly.
- ⚠ WARNING** ALWAYS keep rope away from operator's feet.
- ⚠ WARNING** DO NOT exceed load rating of cable puller, rope or accessories.
- ⚠ WARNING** ALWAYS inspect pulling line or rope before each use.
- ⚠ WARNING** ALWAYS remove the battery pack from your drill before servicing or changing accessories on the puller.
- ⚠ WARNING** ALWAYS ensure cable puller is properly secured to conduit and all pins are in place before operating.
- ⚠ WARNING** Pulling line or rope should be the only thing to contact the capstan. NEVER let swivels, grips, etc. come in contact with the capstan.
- ⚠ WARNING** Pulling line or rope must ALWAYS be pulled over a rotating roller. If a roller does not rotate, turn cable puller off immediately and determine problem before continuing the pull.
- ⚠ WARNING** ONLY use pulling line or rope approved for use with cable pullers. These include polyester measuring/pull tape (mule tape), conduit measuring tape and pulling rope.
- ⚠ WARNING** NEVER allow the rope to slip on a rotating capstan for more than a couple of seconds. The rope will wear in that spot and the rope could break under pressure.
- ⚠ WARNING** Keep all body parts, hair, loose clothing, etc. away from rotating parts and pinch points. Keep hands away from capstan.
- ⚠ WARNING** If you are using pulling rope, DO NOT allow the rope to overlap on the capstan. If this condition begins to occur, immediately release the tailing force on the rope. If this does not remedy the overlap, stop the pull immediately.

IMPORTANT SAFETY INFORMATION *continued*

- ▲ WARNING** ALWAYS inspect pins to be sure they are fully inserted through holes and their detent balls are working. DO NOT substitute any other object for factory supplied pins.
- ▲ WARNING** When making a vertical cable pull, keep the area underneath the cable pull clear of all personnel.
- ▲ WARNING** Keep fingers away from adjustment holes, pivoting parts and capstan. Fingers can be severed by pivoting parts or crushed by rope at the capstan.
- ▲ WARNING** ALWAYS keep children away. All visitors should be kept a safe distance from work area.
- ▲ CAUTION** DO NOT alter this cable puller. Doing so will void the warranty. Guards and safety features are provided for your protection.
- ▲ CAUTION** Wear eye protection when operating the cable puller.
- ▲ CAUTION** Inspect all components of the cable puller before beginning any cable pull. Replace any worn or defective components.
- ▲ CAUTION** Be careful during assembly and disassembly of the cable puller. Have control of components before removing any pins.
- ▲ CAUTION** The drill, gearbox and capstan may heat up during the pull. Be careful.
- ▲ CAUTION** ONLY use a pistol grip style 12V-20V cordless drill. DO NOT use with any other drills, including corded drills, impact drills or cordless drills greater than 20V.

SPECIFICATIONS

Model no.	— 11
Width	— 10"
Height	— 14.5"
Fully extended length	— 55"
Retracted length	— 37.25"
Weight	— 16 lbs. – puller only (no drill)
Maximum pulling force	— 1,000 lbs.
Conduit size range	— 1/2"–4"
Speeds	— <u>no load</u> Low – 10 ft./min. High – 38 ft./min.
Pulling rope	— <u>minimum</u> rated capacity of no less than 1,500 lbs. and an average breaking strength of 6,000 lbs. — rope diameter of 1/4" to 1/2"
Pulling line	— use mule tape, measuring tape or poly line rated for the application

FEATURES

- Quickly mount most battery powered drills for use
- Easily remove pulling line from capstan after use
- Complete unit with no assembly required
- Maintenance free gearbox
- Quick length adjustment for different jobs
- Light weight — cable puller weighs approximately 16 lbs. (without drill)
- One person operation
- Mounting coupling for adding stabilizing leg

FEATURES — CONTINUED

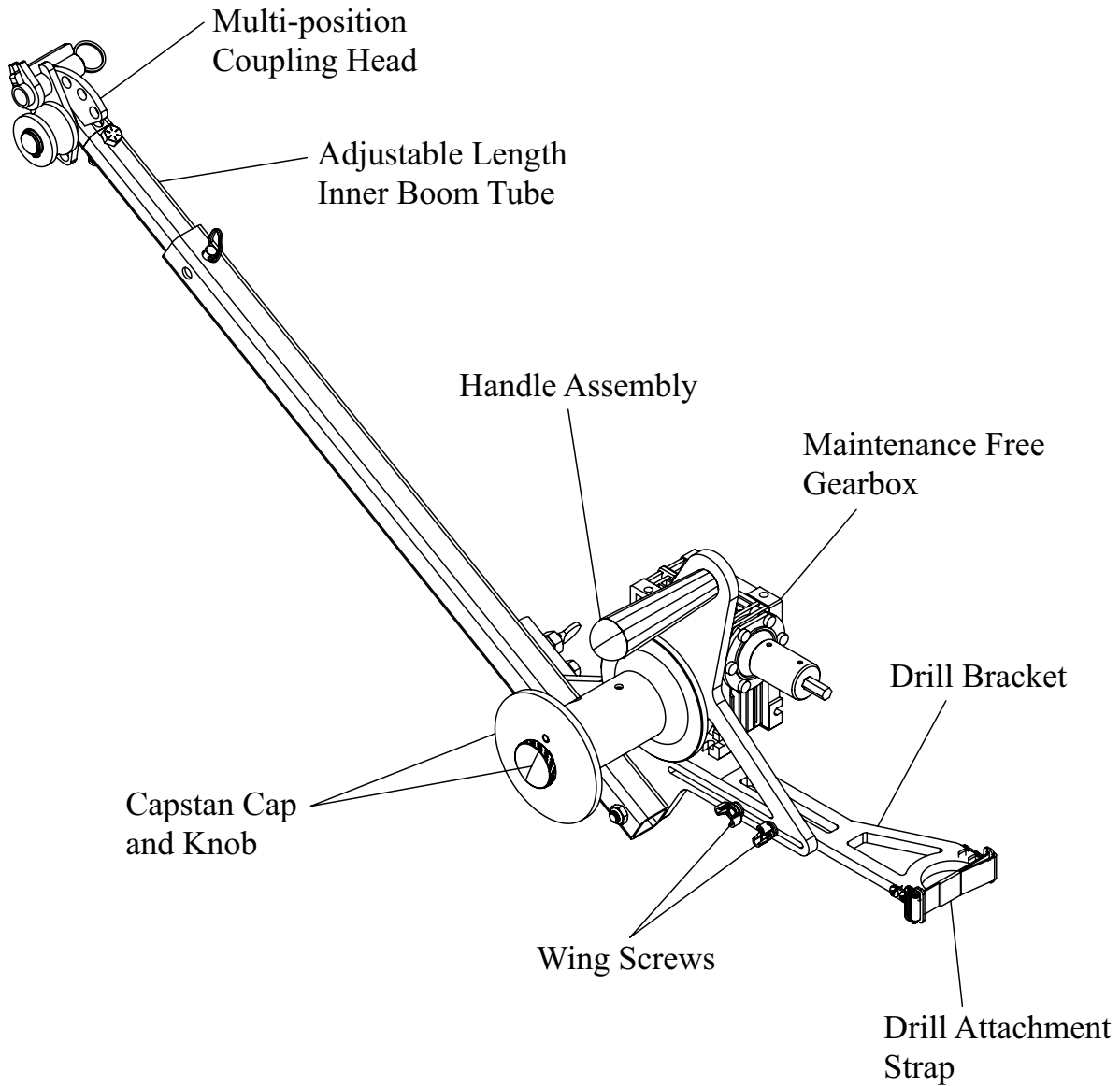

NOTE: See exploded view and parts list on pages 18 & 19 for detailed breakdown.



SET-UP AND OPERATING INSTRUCTIONS

ATTACHING CORDLESS DRILL TO PULLER

WARNING

Drill attachment strap must be properly used during operation. Failure to observe this warning could result in injury.

1. Loosen the wing screws and drill attachment strap on the adjustable drill bracket. Push the bracket to its forward most position.

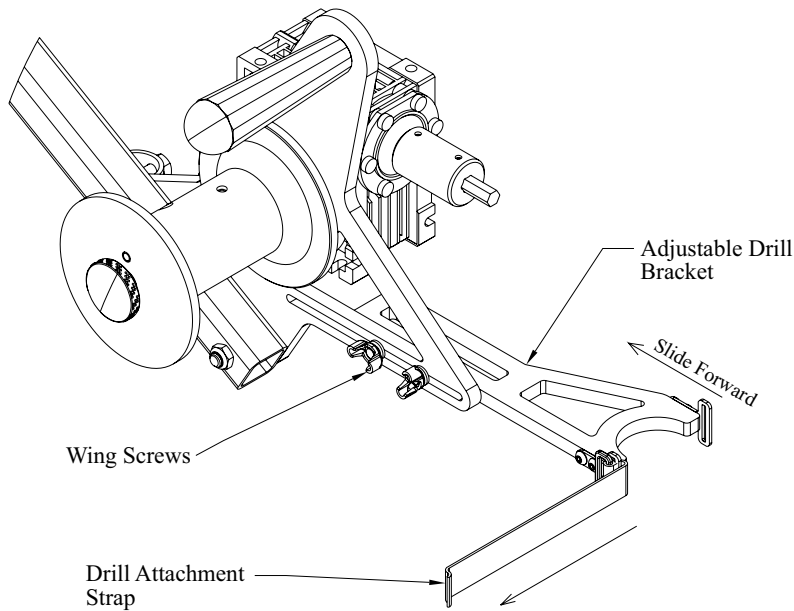

2. Position the cordless drill chuck on the hex drive shaft of the puller gearbox and tighten the chuck.

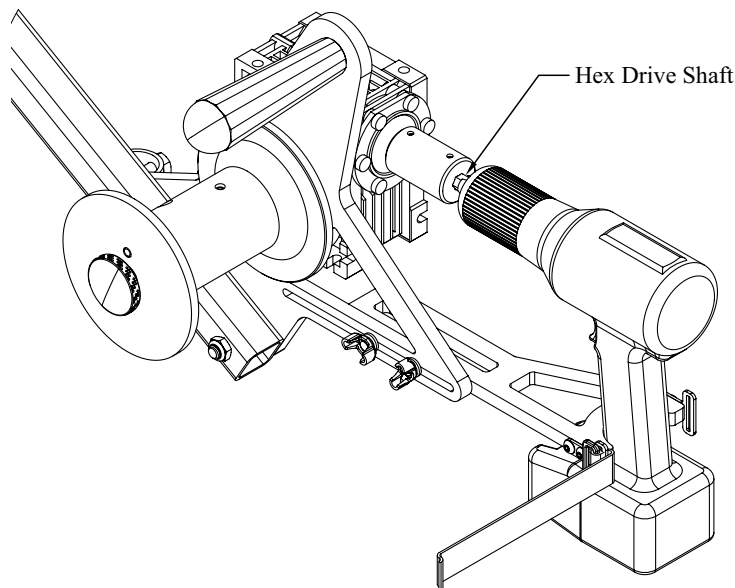

SET-UP AND OPERATING INSTRUCTIONS — CONTINUED

3. Slide the adjustable drill bracket towards the cordless drill until the bracket is snug against the drill. Tighten the bracket wing screws.

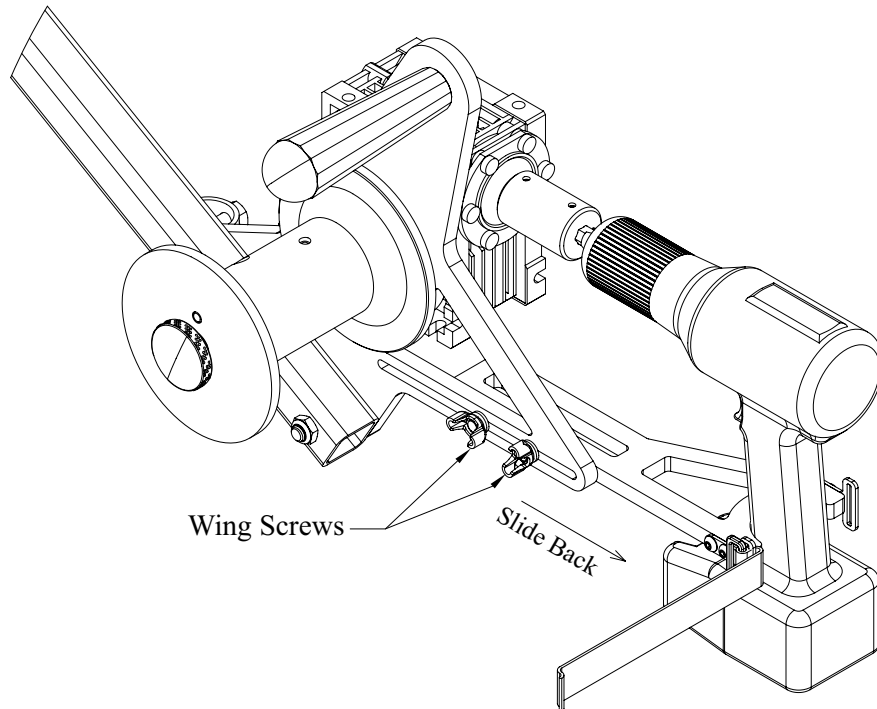

4. Wrap the drill attachment strap around the drill and secure by inserting the strap through the buckle and pull to tighten.

5. Cinch the drill attachment strap using the hook and loop type fastener.

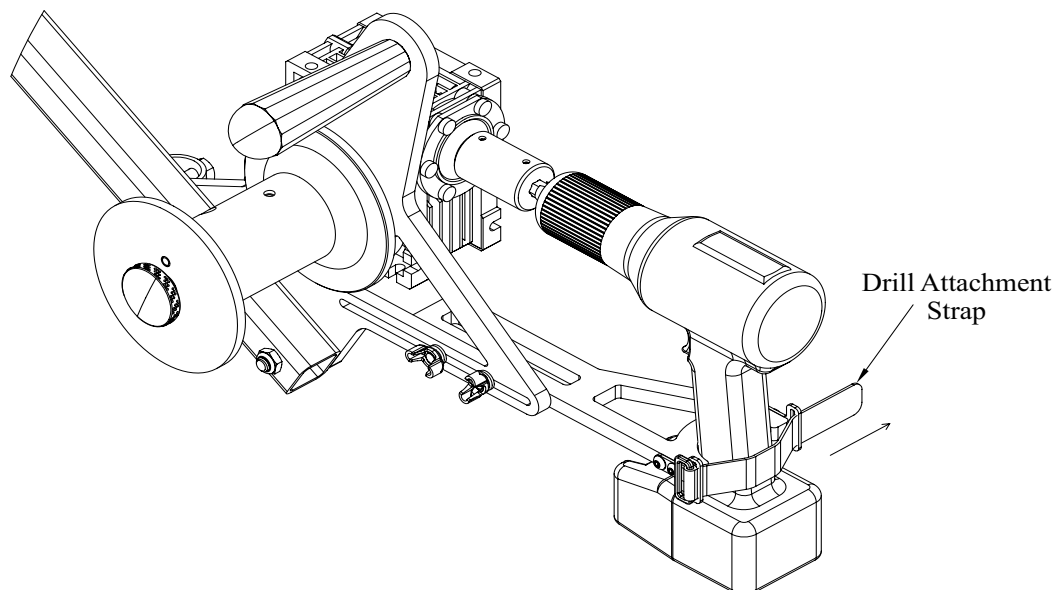

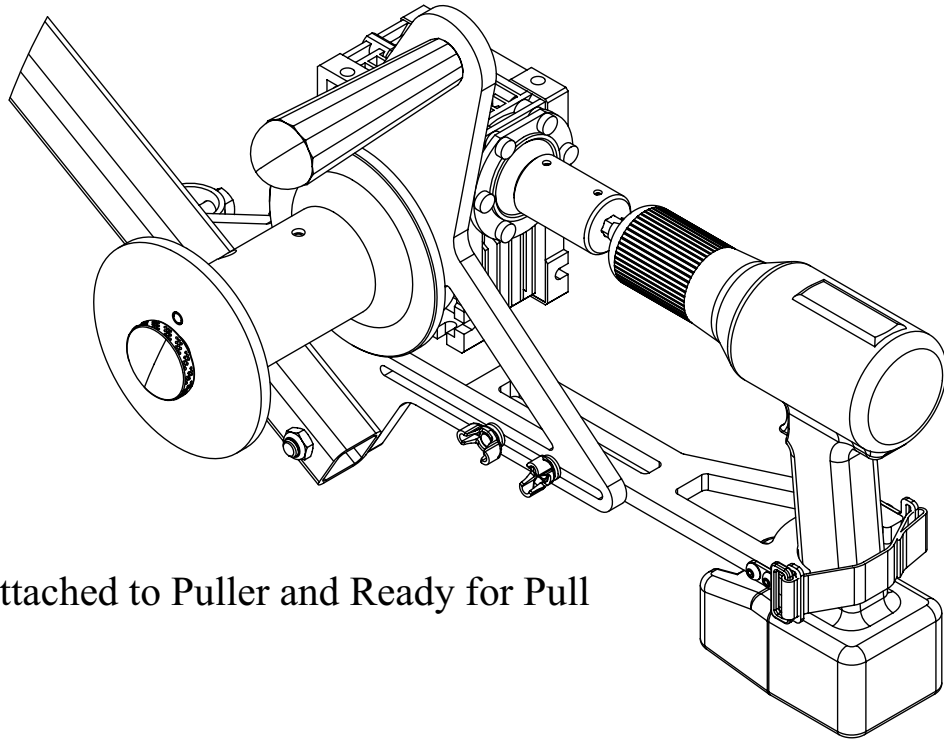

Drill Attached to Puller and Ready for Pull



COUPLING HEAD INSTALLATION AND OPERATION

NOTE: The coupling head on the Model 11 Puller has numerous adjustment positions to allow for the proper angle of engagement to the conduit. To obtain the proper angle, pull the spring loaded retainer pin on the coupling head and adjust the angle of the engagement slot as required.

COUPLING HEAD

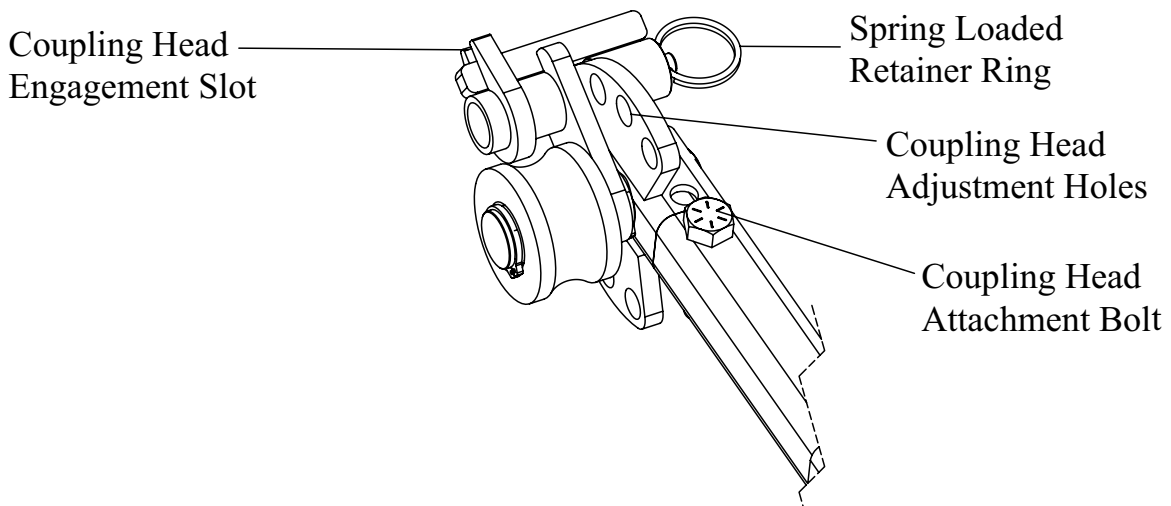

NOTE: The proper angle of engagement allows the engagement slot to fully seat on the lip of the conduit while preventing the pulling line or rope from dragging on the edge of the conduit or other stationary objects in the line of the pull.

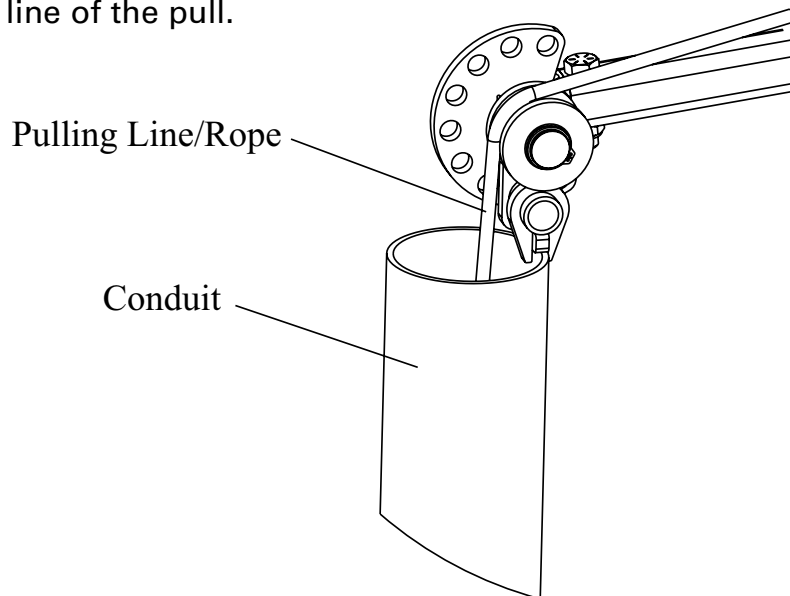



SET-UP AND OPERATING INSTRUCTIONS — CONTINUED

1. The coupling head is secured to the adjustable boom tube with a bolt and should not be removed.
2. To set up the inner boom tube for the type of pull (up, down or side), remove the boom tube detent pin and remove the inner boom tube. Position the boom tube and insert it into the main frame tubing. Replace the detent pin at the desired length to secure the boom tube (see page 17 for common pulling set ups).

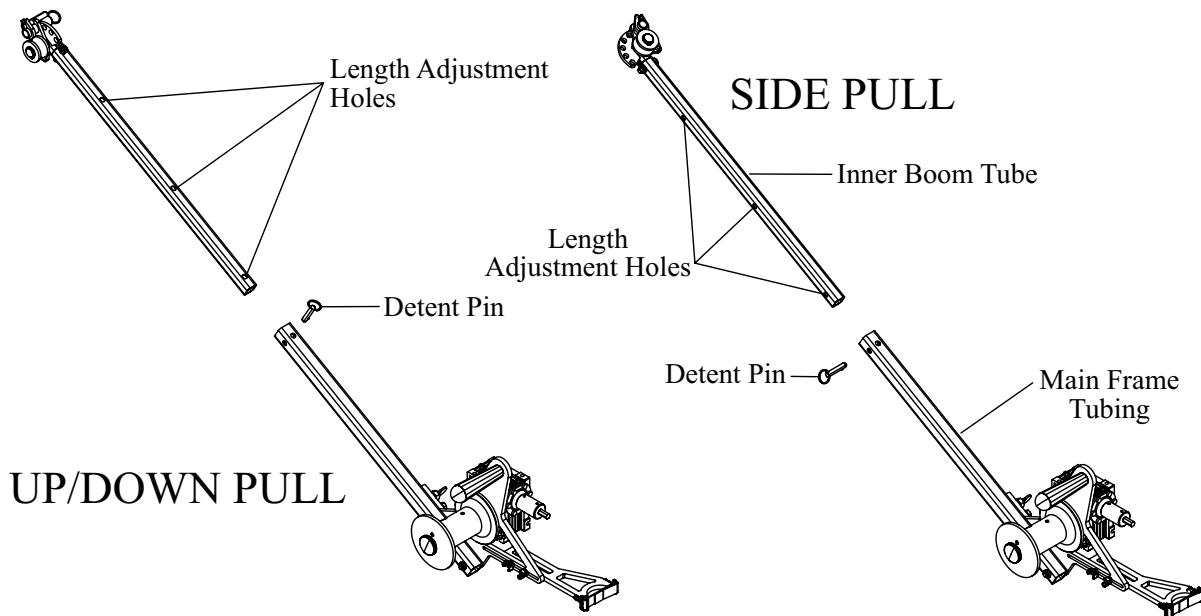

NOTE: The coupling head engagement slot must properly engage the conduit or conduit nut. In addition, the rope or pulling line should NEVER contact the edge of the conduit you are pulling in or any stationary part of the puller.



PULLING CABLE

NOTE: The following instructions should be referred to when using **polyester measuring/pulling tape (mule tape) or conduit measuring tape** that is approved for cable pulling. These are referred to below as “pulling line”.

1. The pulling line must be attached to the capstan in order for it to spool during the pull. The two options to attach the pulling line to the capstan are noted below:

OPTION 1 Insert the pulling line through the hole in the capstan and tie a knot to hold it on the capstan. See Figure 13A.

FIGURE 13A

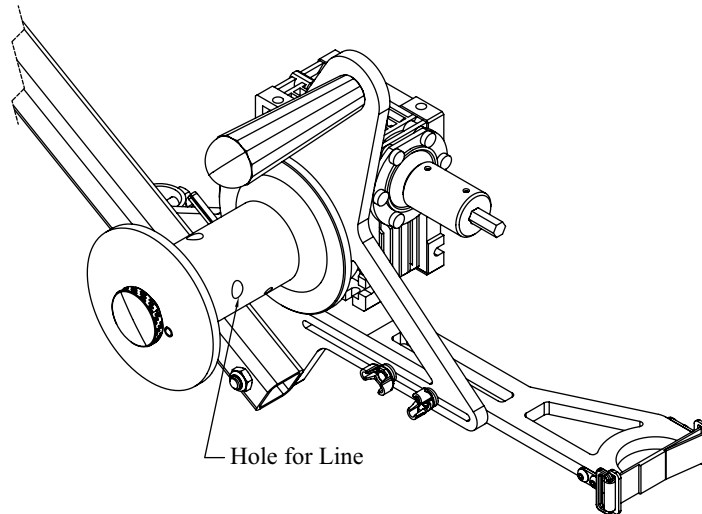

OPTION 2 Unscrew the capstan cap knob a few turns to loosen the cap. Insert the pulling line between the capstan cap and capstan. Then fully tighten the capstan cap knob to capture the pulling line between the capstan cap and capstan.

NOTE: Ensure the alignment hole in the capstan cap lines up with the dowel pin on the capstan when tightening. See Figure 13B.

FIGURE 13B

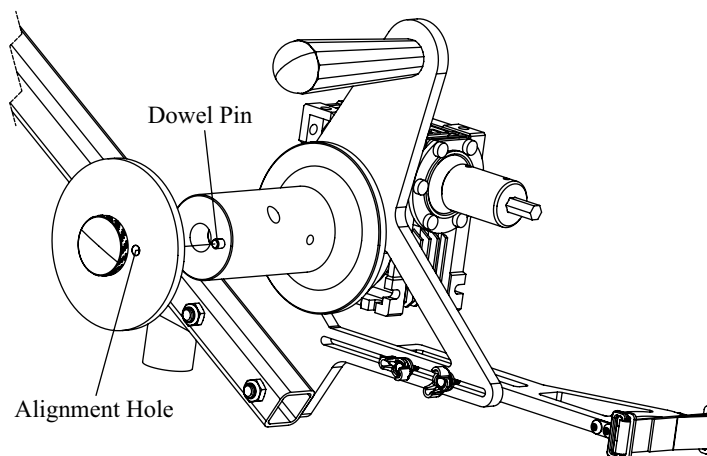



SET-UP AND OPERATING INSTRUCTIONS — *CONTINUED*

2. If necessary, adjust the boom length and the position of the coupling head to ensure that the coupling head engagement slot is fully seated on the lip of the conduit.

3. If pulling cable, set the cordless drill direction to FORWARD or CLOCKWISE and the speed to low. Pull the trigger on the cordless drill to start the pull.

NOTE: If preferred, you may set the cordless drill direction to REVERSE or COUNTER-CLOCKWISE when using pull line (not pulling rope).

NOTE: When pulling cable, LOW speed is recommended to avoid damaging the cable during the pull.

4. The pulling line will spool up on the capstan. If adjustments need to be made to the spooling line, STOP THE DRILL before making any adjustment.

5. After the pull is completed, disconnect the pulling line from the rope, cable or wire that was pulled. To remove the pulling line from the capstan, unscrew the capstan cap knob and remove the capstan cap. Slide the pulling line off of the capstan.

6. Re-install the capstan cap and tighten the capstan cap knob.

NOTE: Ensure the alignment hole in the capstan cap lines up with the dowel pin on the capstan when tightening. See Figure 13B.



SET-UP AND OPERATING INSTRUCTIONS — CONTINUED

PULLING CABLE — continued

NOTE: The following instructions should be referred to when using **approved pulling rope** on the Model #11 puller.

1. If necessary, adjust the boom length and the position of the coupling head to ensure that the coupling head engagement slot is fully seated on the lip of the conduit.
2. Position the rope from the conduit over the coupling head roller and onto the capstan.
3. Start at the end of the capstan closest to the gearbox and wrap the rope in a clockwise direction around the capstan two or three wraps. Ensure the rope is laying side by side on the capstan, and the tailing end is coming off the top of the capstan.

NOTE: The tailing end is the portion of the rope that has passed the capstan and is now excess to the pull. By pulling on the tailing rope the operator can control and vary the pulling force. If the rope slips on the capstan, stop the cordless drill and add an additional wrap of rope around the capstan.

4. Set the cordless drill direction to FORWARD or CLOCKWISE and the speed to low. Pull the trigger on the cordless drill to start the pull.
5. Using your free hand, pull the tailing end of the rope while the capstan is turning. This will tighten the rope onto the capstan and begin to pull the cable. Continue pulling the rope until the pull is completed.
6. Once the pull is completed, unwrap the rope from the capstan.

SET-UP AND OPERATING INSTRUCTIONS — CONTINUED

OPTIONAL: Mounting a stabilizing leg

1. Cut a piece of 1/2" Rigid conduit to your desired length. One end of the conduit must be threaded.
2. Screw the piece of 1/2" Rigid conduit into the adapter coupling, ensuring full thread engagement.

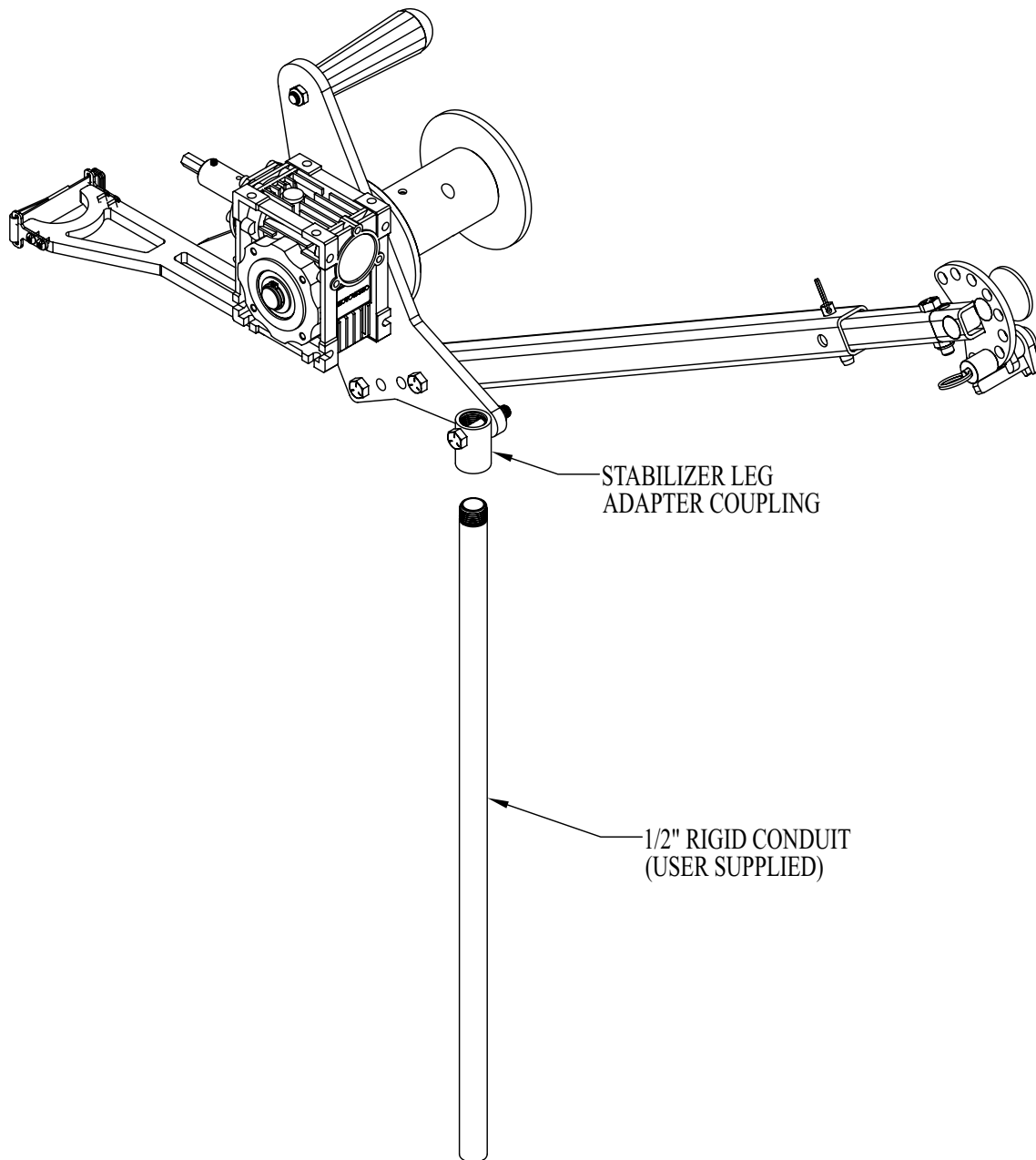

COMMON SET-UPS



UP PULL



DOWN PULL



SIDE PULL



EXPLODED VIEW – MODEL 11 CABLE PULLER

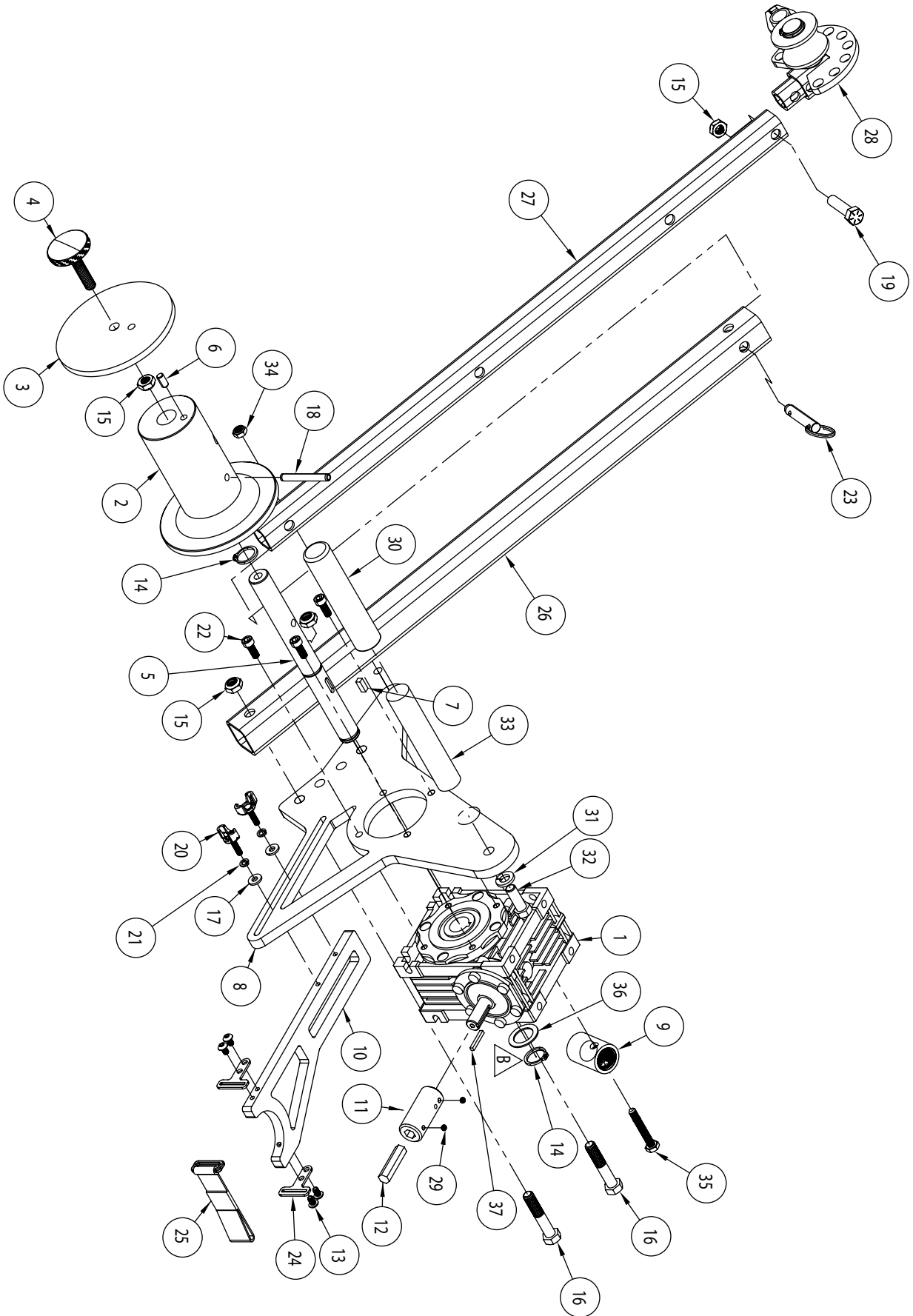



PARTS LIST – MODEL 11 CABLE PULLER

ITEM NO.	PART NUMBER	DESCRIPTION	QTY.
1	11-001	GEARBOX	1
2	11-005	CAPSTAN	1
3	11-006	CAPSTAN END PLATE	1
4	11-008	RELEASE KNOB (3/8" x 1.5")	1
5	11-003	DRIVE SHAFT	1
6	11-007	DOWEL PIN (1/4" OD x 1/2")	1
7	11-134	KEY STOCK - 3/16" X 3/16" x 1/2"	1
8	11-009	MAIN FRAME	1
9	11-115	LEG ADAPTER COUPLING	1
10	11-018	LOWER FRAME	1
11	11-101	DRIVE ADAPTER	1
12	754-186	HEX SHAFT-ADAPTER	1
13	163-11	SCREW-BUTTON HEAD SOCKET (10-32 x 5/16")	4
14	2-1109	SNAP RING - 3/4"	2
15	610-25	NUT-HEX NYLON INSERT (3/8-16)	4
16	528-2	SCREW-HEX HEAD CAP GR5 ZINC (3/8-16 x 2)	2
17	450-14J	WASHER-FLAT SAE #10	2
18	11-004	ROLL PIN (1/4" OD x 2")	1
19	754-015	SCREW-HEX HEAD CAP GR5 ZINC (3/8-16 x 1.5)	1
20	11-019	WING SCREW (10-32 x 3/4")	2
21	11-027	LOCK WASHER (#10)	2
22	11-002	SOCKET HEAD CAP SCREW (M6 x 16)	4
23	11-024	QUICK RELEASE PIN (3/8" x 1-5/16")	1
24	11-107	STRAP CLIP	2
25	11-022	DRILL ATTACHMENT STRAP	1
26	11-117	OUTER BOOMTUBE	1
27	11-118	INNER BOOMTUBE	1
28	11-133	HEAD ASSEMBLY	1
29	11-033	SCREW-SET, # 10-32 x 1/8"	2
30	705-8	GRIP	1
31	452-27	WASHER - LOCK, 3/8	1
32	524-11	SCREW-HX HD CAP, 3/816 x 1"	1
33	11-010	HANDLE - ALUMINUM	1
34	747-30	NUT—HEX, THIN NYLON INSERT (1/4—20)	1
35	610-3	SCREW — HEX HD CAP, 1/4—20 x 1.75"	1
36	11-138	WASHER — 3/4" S.S.	1
37	11-139	KEY, 1/8" x 1/8" x 7/8" (INCLUDED WITH ITEM #1)	1